

Downers Grove Civic Center

825 Burlington Ave, Downers Grove, IL 60515

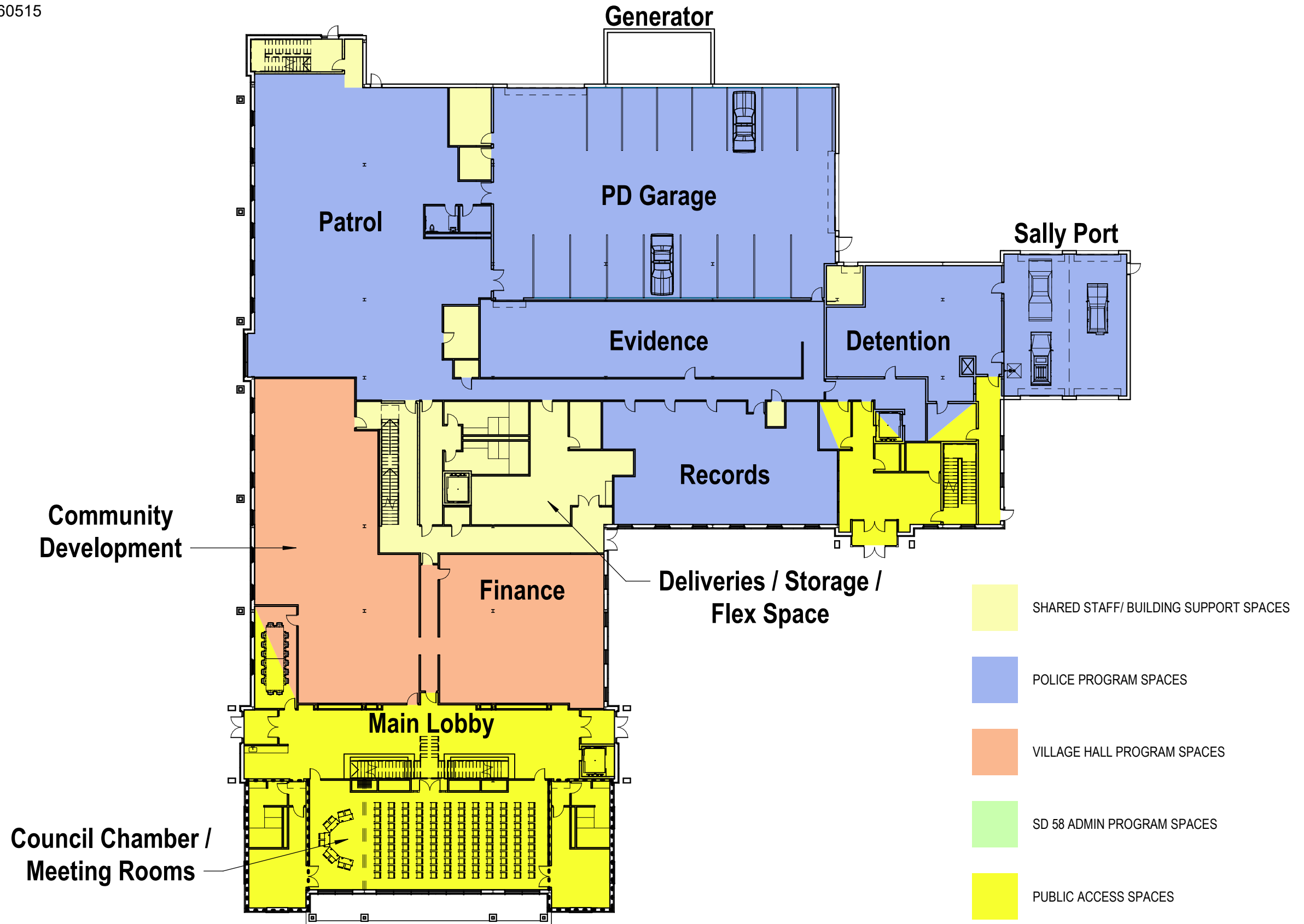

FIRST FLOOR PLAN

SCALE: 1' = 30'
OVERALL AREA: 38,100 SF

Village of Downers Grove
Job No. 22-3818.01

Published 03/03/22
©2022 FGM Architects Inc.



Downers Grove Civic Center

825 Burlington Ave, Downers Grove, IL 60515

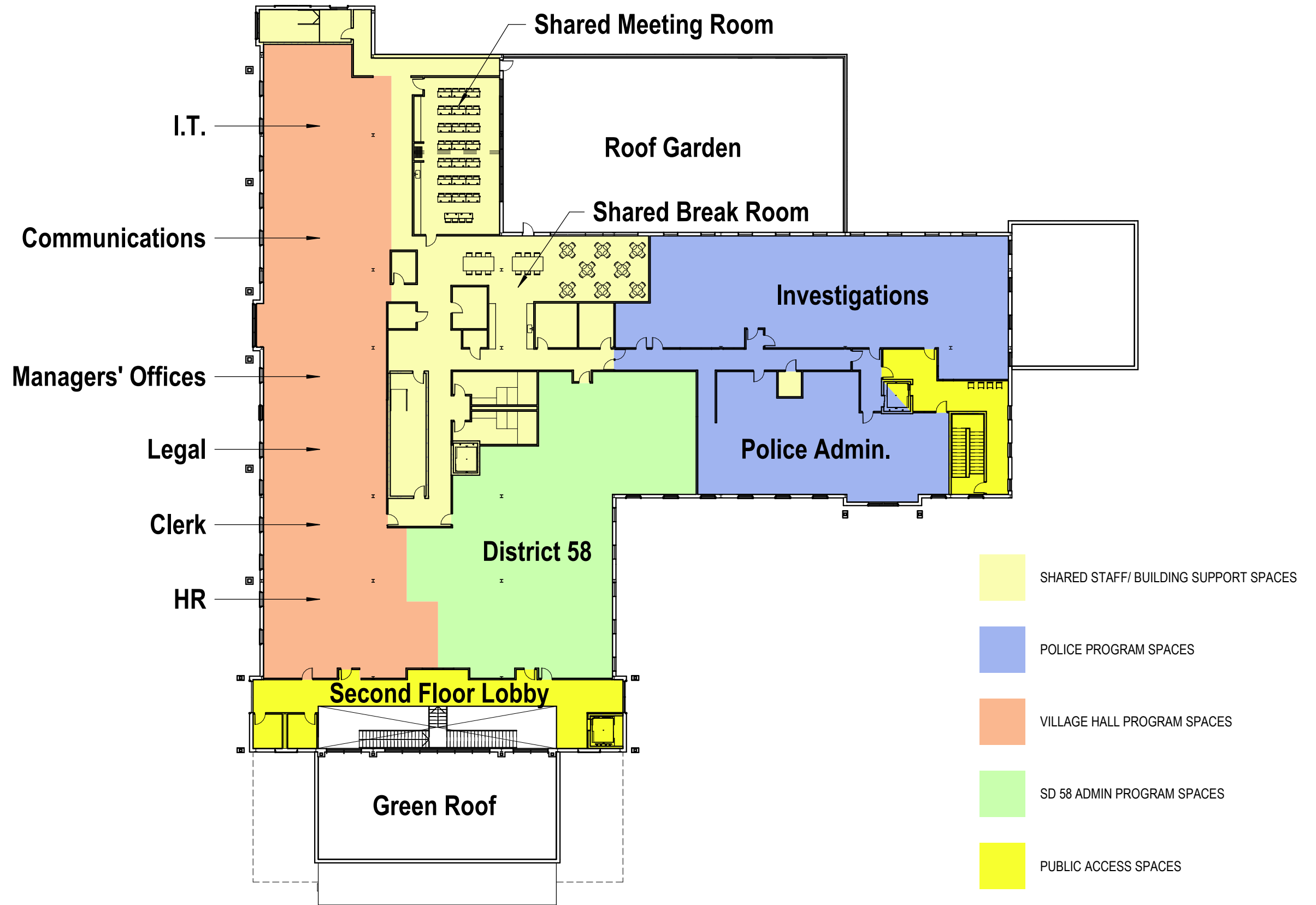

SECOND FLOOR PLAN SCALE: 1" = 30'
OVERALL AREA: 27,800 SF (INCLUDING 800 SF LOBBY STAIR OPENING)

Village of Downers Grove
Job No. 22-3818.01

Published 03/03/22
©2022 FGM Architects Inc.



Downers Grove Civic Center

825 Burlington Ave, Downers Grove, IL 60515

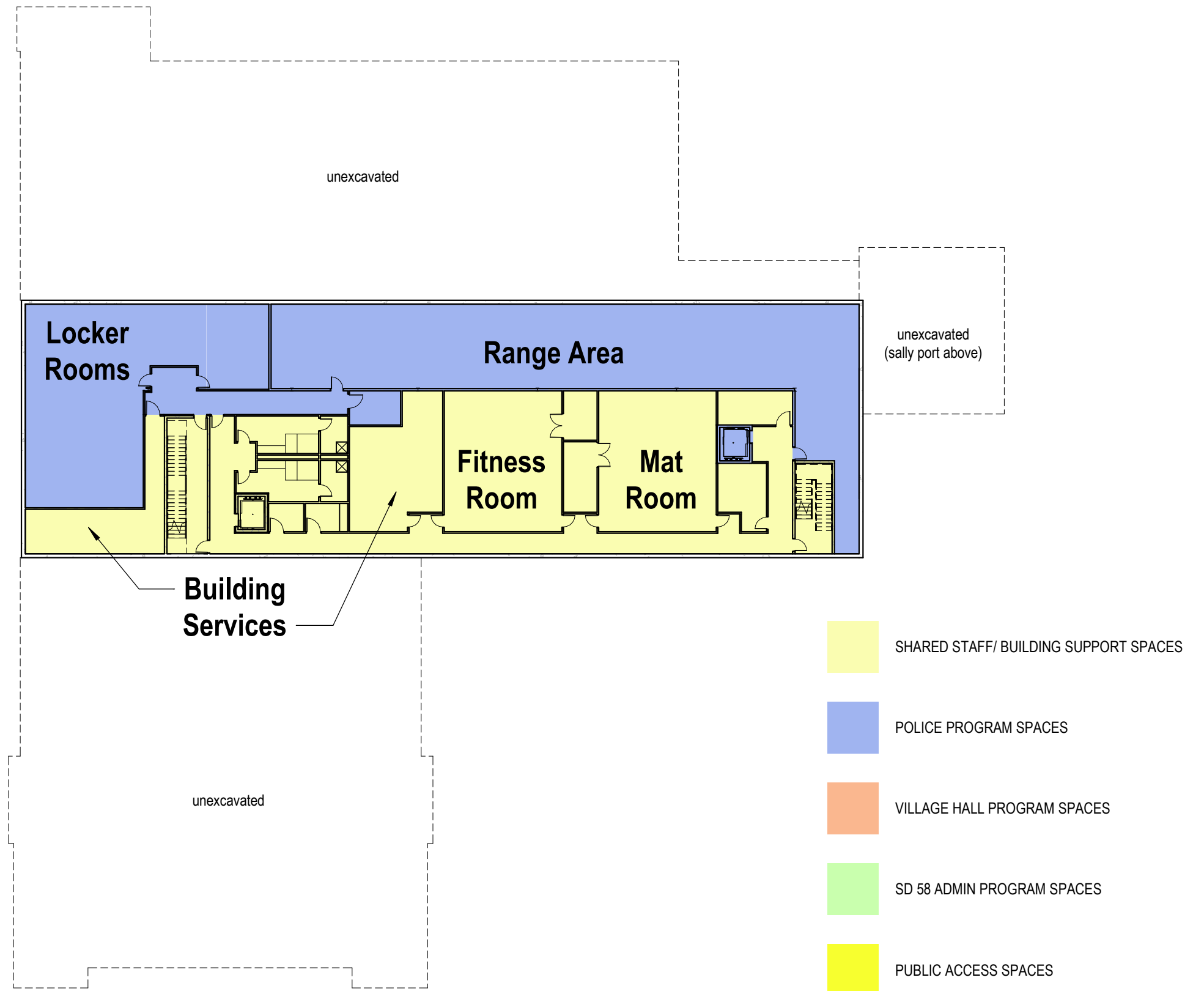

BASEMENT

SCALE: 1" = 30"
OVERALL AREA: 14,100 SF

Village of Downers Grove
Job No. 22-3818.01

Published 03/03/22
©2022 FGM Architects Inc.

