

**VILLAGE OF DOWNERS GROVE
COUNCIL ACTION SUMMARY**

INITIATED: Applicant **DATE:** June 4, 2002
(Name)

RECOMMENDATION FROM: _____ **FILE REF:** _____
(Board or Department)

NATURE OF ACTION:

- Ordinance
- Resolution
- Motion
- Other

STEPS NEEDED TO IMPLEMENT ACTION:

Motion to Adopt "AN ORDINANCE ANNEXING CERTAIN TERRITORY COMMONLY KNOWN AS 4929 CROSS STREET TO THE VILLAGE OF DOWNERS GROVE, ILLINOIS", as presented.", as presented.



SUMMARY OF ITEM:

Adoption of this Ordinance will annex the property commonly known as 4929 Cross Street. Following annexation, this property will be rezoned to R-1 Single Family Residential.

RECORD OF ACTION TAKEN:

ORDINANCE NO. _____

**AN ORDINANCE ANNEXING CERTAIN TERRITORY
COMMONLY KNOWN AS 4929 CROSS STREET
TO THE VILLAGE OF DOWNERS GROVE, ILLINOIS**

WHEREAS, there has been filed with the Clerk of the Village of Downers Grove, in DuPage County, Illinois, a verified petition requesting annexation to said Village of certain territory as hereinafter described and hereafter referred to as the "Territory"; and

WHEREAS, it appears that the owner or owners of record of each parcel of land within the Territory and at least fifty-one percent (51%) of the electors, if any, residing therein, have joined in said petition; and

WHEREAS, it appears to be in the best interests of the Village of Downers Grove to annex the Territory.

NOW, THEREFORE, BE IT ORDAINED by the Council of the Village of Downers Grove, in DuPage County, Illinois, as follows:

SECTION 1. The following described real estate, together with any public streets or highways adjacent to or within the Territory described that have not been previously annexed to any municipality, is hereby annexed to the Village of Downers Grove, to wit:

Lot 19 in Block 9 in Carpenter's Addition to Lacton, being a subdivision in the Northwest Quarter of Section 12, Township 38 North, Range 10 East of the Third Principal Meridian according to the plat thereof recorded June 12, 1890 in DuPage County, Illinois, commonly known as 4929 Cross Street, Downers Grove, IL 60515 (PIN 08-12-109-020)

Pursuant to Illinois Revised Statutes Chapter 24 entitled "Cities and Villages", the new boundary of the territory to be annexed shall extend to the far side of any adjacent highway and shall include all of every highway within the area to be annexed.

SECTION 2. A certified copy of this ordinance, together with an accurate map of the Territory hereby annexed shall be recorded in the office of the Recorder of DuPage County and shall be filed with the County Clerk of DuPage County by the Clerk of the Village.

SECTION 3. If any section, subsection, sentence, clause, phrase or portion of this ordinance is for any reason held invalid or unconstitutional by any court of competent jurisdiction, such portion shall be deemed a separate, distinct, and independent provision and such holding shall not affect the validity of the remaining portions hereof.

SECTION 4. All ordinances or resolutions, or parts thereof, in conflict with the provisions of this ordinance be and are hereby repealed.

SECTION 5. This ordinance shall be in full force and effect from and after its passage and publication in the manner provided by law.

Mayor

Passed:

Published:

Attest: _____

Village Clerk

PLAT OF ANNEXATION

TO
THE VILLAGE OF DOWNERS GROVE
OF

Associated Surveying Group, P.C.
P.O. Box 810 Bolingbrook, IL 60440
PH (630) 759-0205 FAX (630) 759-9291

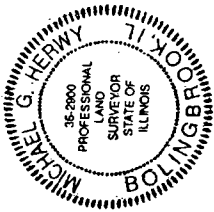

LOT 19 IN BLOCK 9 IN CARPENTER'S ADDITION TO LACTON, BEING A SUBDIVISION IN THE NORTHWEST QUARTER OF SECTION 12, TOWNSHIP 38 NORTH, RANGE 10, EAST OF THE THIRD PRINCIPAL MERIDIAN, ACCORDING TO THE PLAT THEREOF RECORDED JUNE 12, 1890 AS DOCUMENT 42886, IN DUPAGE COUNTY, ILLINOIS.

ALSO
PURSUANT TO ILLINOIS REVISED STATUTES CHAPTER 24 ENTITLED "CITIES AND VILLAGES", THE NEW BOUNDARY OF THE TERRITORY TO BE ANNEXED SHALL EXTEND TO THE EAST SIDE OF ANY ADJACENT HIGHWAY AND SHALL INCLUDE ALL OF EVERY HIGHWAY WITHIN THE AREA TO BE ANNEXED.

VILLAGE OF DOWNERS GROVE

STATE OF ILLINOIS }
COUNTY OF DUPAGE } SS

THIS PLAT OF ANNEXATION IS IDENTIFIED AS THAT INCORPORATED INTO AND MADE A PART OF THE VILLAGE OF DOWNERS GROVE BY ORDINANCE NO. _____, ADOPTED BY THE COUNCIL OF SAID VILLAGE ON THE _____ DAY OF _____, 2002, A.D.

ATTEST: _____ BY _____ MAYOR
VILLAGE CLERK

COUNTY RECORDER'S CERTIFICATE

STATE OF ILLINOIS }
COUNTY OF DUPAGE } SS

THIS INSTRUMENT _____ WAS FILED FOR RECORD IN THE RECORDER'S OFFICE OF DUPAGE COUNTY, ILLINOIS ON THE _____ DAY OF _____, 2002, A.D., AT _____ O'CLOCK, _____ M., AND WAS RECORDED IN BOOK _____ OF PLATS ON PAGE _____

RECORDER OF DEEDS

SURVEYOR'S CERTIFICATE

STATE OF ILLINOIS }
COUNTY OF DUPAGE } SS

THIS IS TO CERTIFY THAT I, MICHAEL G. HERWY, ILLINOIS PROFESSIONAL LAND SURVEYOR NO. 35-2900, HAVE PREPARED THIS PLAT FROM EXISTING PLATS AND RECORDS FOR THE PURPOSE OF ANNEXATION TO THE VILLAGE OF DOWNERS GROVE, ILLINOIS. ALL DISTANCES ARE SHOWN IN FEET AND DECIMAL PARTS THEREOF.

GIVEN UNDER MY HAND AND SEAL THIS 25TH DAY OF APRIL, 2002, A.D.

Michael G. Herwy
MICHAEL G. HERWY
ILLINOIS PROFESSIONAL LAND SURVEYOR NO. 35-2900
LICENSE EXPIRES: NOVEMBER 30, 2007

For holding the seal and other restrictions not shown on the Survey file, refer to your abstract, deed, and local building regulations.

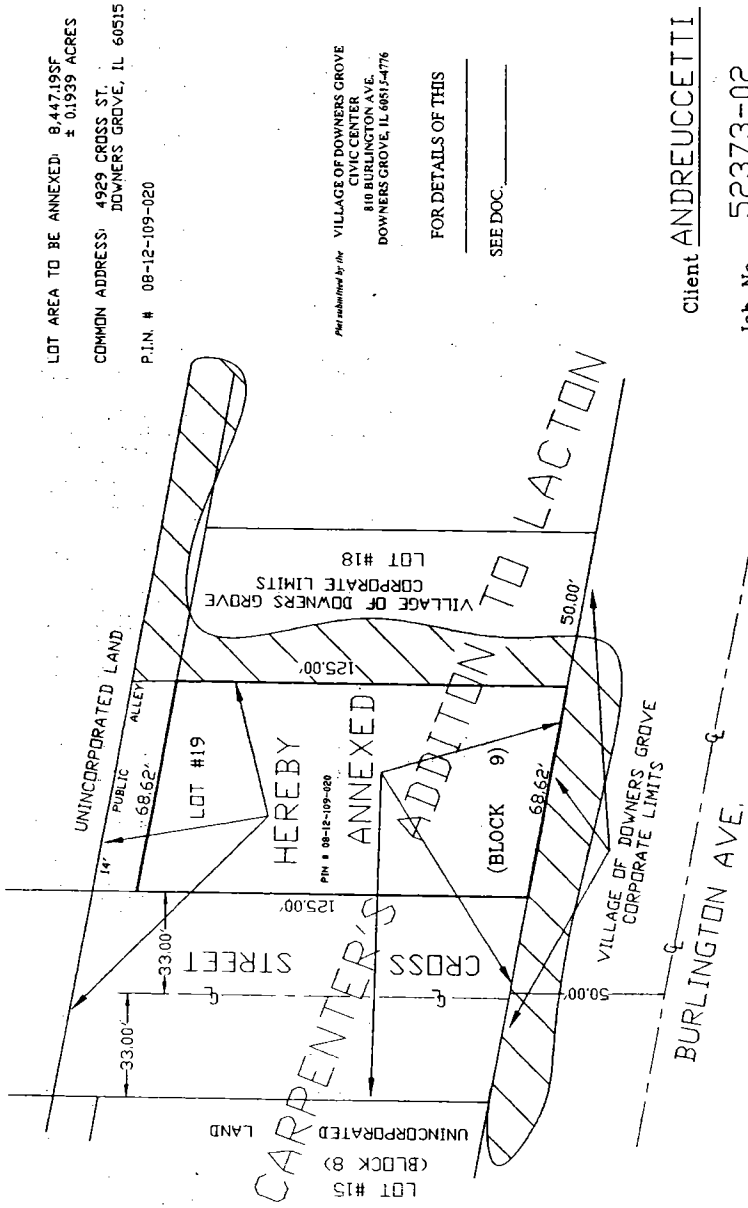

LOT AREA TO BE ANNEXED: 8,447.19SF
± 0.1939 ACRES
COMMON ADDRESS: 4929 CROSS ST.
DOWNERS GROVE, IL 60515
P.I.N. # 08-12-109-020

Prepared by the
VILLAGE OF DOWNERS GROVE
CIVIC CENTER
810 BURLINGTON AVE.
DOWNERS GROVE, IL 60515-4776

FOR DETAILS OF THIS
SEE DOC. _____

Client ANDREUCCETTI

Job No. 52373-02

4929
Cross