

## COUNCIL WORKSHOP ITEM

**ITEM:** PURCHASE OF REPLACEMENT AMBULANCE  
**DATE:** August 8, 2001  
**PREPARED BY:** Fire Chief Lanny Russell  
**PURPOSE:** Replace ambulance at Station 2 with a new medium duty unit identical to the ones purchase last year.  
**BID AMOUNT:** \$128,131 **ACCOUNT:** 960-530-0000-5836  
**BUDGET AMOUNT:** \$130,000

### DISCUSSION:

When the Fire Department last purchased ambulances we purchased two units in 1993 with funds coming from two fiscal years. This allowed us a discount for purchasing two units at the same time. The third unit was purchased in 1994 and at that time Council allowed us to purchase an identical unit from the same vendor. This process has several advantages. First, with all three front line ambulances identical, the medics know where everything is located regardless of where they are working on any particular day. This is also helpful for Fleet Maintenance as they have three identical units to maintain.

We received two Medtec medium duty ambulances in August 2000 that were purchased with funds from FY 1999-2000 and 2000-2001. We have a third unit budgeted in this fiscal year and are requesting that Council allow us to follow the same policy and purchase an identical unit to the two received last year.

The two units that were purchased last year cost \$252,162 and we received a discount of \$2,000 each for a net cost of \$126,081 before the multi-unit discount. We have received a proposal from Foster Coach Sales, Inc. to purchase an identical Medtec unit for \$128,131 including the trade-in of the 1993 ambulance.

### ATTACHMENT:

Attached is the proposal from Foster Coach for an ambulance identical to the units that were received in August 2000.

### RECOMMENDATION:

It is the recommendation of the Fire Department and Fleet Maintenance that Council waive the bidding requirements and approve the purchase of a new Medtec ambulance from Foster Coach Sales Inc. in the amount of \$128,131.

# FOSTER COACH SALES, INC.

1231 W. 4th Street P.O. Box 700  
Sterling, Illinois 61081  
Phone: (815) 625-3276  
800-369-4215

## PROPOSAL

To: Village of Downers Grove  
801 Burlington Avenue  
Downers Grove, Illinois 60515

Attn: Lt. Dan Mejdrech

Date: June 26, 2001

Reference: New Ambulance

We are pleased to submit the following quotation in accordance with your request and subject to the Terms and Conditions listed below and on the reverse side hereof.

DESCRIPTION	NET PRICE
One new 2001 Medtec "Voyager II" ambulance conversion mounted on 2002 Freightliner FL50 chassis. This vehicle shall be built in accordance with the enclosed Freightliner chassis specifications, Medtec basic specifications, enclosed Freightliner chassis specifications, list of your requested options and custom drawings.	
One (1) 2002 Freightliner FL50 chassis per enclosed specifications.	\$ 50,495.00
One (1) 2001 Medtec "Voyager II" modular body conversion	\$ 58,330.00
Requested additional options as listed	\$ 23,806.00
This unit complete and delivered for	\$ 132,631.00
Trade-in of your 1993 Medtec "Atlas" Type I ambulance.	\$ 4,500.00
Total amount due upon delivery	\$ 128,131.00

Please note that Foster Coach Sales, Inc. does not add any interest to the price of the chassis. Your actual delivered cost of the chassis is listed on the front page of the Freightliner specifications. the cost of the chassis is due no later than 30 days after delivery. Your village will be notified i sufficient time so that payment of the chassis should not be a problem. Chassis payment would be made out to Foster coach Sales, Inc. Balance due upon delivery and acceptance.

**Please refer to our cover letter for information regarding additional discounts available.**

ACCEPTED BY: \_\_\_\_\_

TITLE: \_\_\_\_\_ DATE: \_\_\_\_\_

**ESTIMATED DELIVERY:**

Approximately 120 TO 150 calendar days after receipt of chassis at Medtec Ambulance Corp. in Goshen, Indiana and approval of production order.

FOSTER COACH SALES, INC.

PROPOSED BY: \_\_\_\_\_

Regional Sales Manager

DATE: 6/26/01

# FOSTER COACH SALES, INC.

1231 West Fourth Street Post Office Box 700 Sterling, Illinois 61081-0700  
Phone (815)625-3726 Toll-Free 1-800-369-4215 Fax (815)625-7222

June 26, 2001

Lt. Dan Mejdrech  
Village of Downers Grove  
801 Burlington Avenue  
Downers Grove, Illinois 60515

Dear Lt. Mejdrech:

Foster Coach Sales, Inc. is pleased to submit the enclosed proposal for one 2001 Medtec "Voyager II" ambulance conversion mounted on a 2002 Freightliner FL50 chassis as per enclosed specifications and list of Medtec and Foster Coach provided options. Please note that this proposal does not include cost for Performance Bond. If a Performance Bond is required, an additional cost of \$2.00 per thousand or \$256.00 would prevail.

The chassis cost of \$50,495.00 would be due no later than thirty days after delivery of chassis. If for some reason your village chose not to pay for the chassis upon delivery and chose to pay the whole amount for the chassis and conversion at time of delivery, Foster Coach would have to add \$2,000.00 interest charges for the chassis. I have been advised by Freightliner that estimated lead time for chassis is approximately sixty to ninety days after ordering. As before, this chassis will be delivered to Truck Country Freightliner dealer in Rockford, Illinois. At this time chassis will receive a PDI and will be available for members of the Downer Grove Fire Department to inspect it.

This revised proposal reflects the deletion of Foster Coach reimbursing the radio installer of your choice for \$240.00. The revised enclosed chassis specifications reflect the fact the front axle and rear axle outside wheels will be Alco polished aluminum. Rear axle inside wheels will be steel. Please refer to the enclosed letter from Kevin Watt stating that he checked with Freightliner engineering and found that the issue of corrosion between aluminum and steel wheels and a difference in heat dispersion has been resolved by using a nylon spacer between the wheels. Kevin Watt also told me verbally that the front and rear axle wheels are not interchangeable.

At our last meeting you gave me a brochure regarding the No Smoke diesel exhaust filtration system. I passed this information on to Kevin Watt at our Freightliner dealership. He contacted this company and was told that Downers Grove had already contacted them and was anticipating a possible purchase of five or more of these units. He was told that this company will come to your station and install this after market equipment. Kevin Watt was also told that if Downers Grove ordered five or more units, the price would be \$8,488.00 per unit. The price of one unit would be \$9,628.00. Since neither Foster Coach nor Truck Company of Rockford had ever heard of this system, we do not want to be involved in the installation of it. Mainly, because if there is a problem, we do not want to be held responsible. We feel it would be better if you dealt directly with this company.

Foster Coach Sales, Inc. has been in business since 1957 and offers a complete line of professional vehicles, service facilities, body shop, loaner vehicles, remount facility and extensive parts inventory. We pride ourselves on quality products, at a reasonable price, backed by the best service in the ambulance field. Our continued growth is evidence of our success at doing just that, thus letting us be the oldest dealer in Iowa, Missouri, Wisconsin and Illinois serving ambulance squads, hospitals, private services and city and county government. If you have any questions, please feel free to call me.

Sincerely,

Foster Coach Sales, Inc.

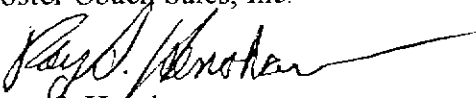
A handwritten signature in cursive script, reading "Ray S. Henshaw", with a long horizontal flourish extending to the right.

Ray S. Henshaw

Regional Sales Manager

# Foster Coach Sales, Inc.

1231 West Fourth Street Post Office Box 700 Sterling, Illinois 61081

## FAX COVER SHEET

Date: 8/1/01

To: Lt. Dan Mejdrech Fax #1-630-434-5988

From: Ray Henshaw

Total number of pages sent (including cover sheet) 17

This fax consist of:

(1) fax sheet

(7) pages of revised options dated 8/1/01

(9) pages of revised Freightliner chassis specifications dated 7/31/01

As I probably told you, Butch is no longer with this Freightliner dealer. Our new dealer is Kevin Watt who I think you may have met. He told me that the 2001 chassis dash gauge lay-out is different than what your two original chassis have. In the dash area there is a gauge that will warn the driver that the engine air cleaner is becoming obstructed. This would replace the plastic gauge under the hood for the air cleaner.

Hopefully these revisions meet with your approval. I will be at the factory all day Thursday August 2nd. If you have any questions, call me on Friday.

**Foster Coach Sales, Inc. Fax Number : 1- 815-625-7222**

**Phone Number: 1-800-369-4215**

**Ray Henshaw Fax number: 1-708-579-9481**  
**La Grange Office**

**If you do not receive all pages please call Foster Coach Sales, Inc.**

## FOSTER COACH SALES, INC.

1231 West Fourth Street Post Office Box 700 Sterling, Illinois 61081-0700

Phone (815)625-3728 Toll-Free 1-800-369-4215 Fax (815)625-7222

### DOWNERS GROVE FIRE DEPARTMENT

August 1, 2001

### OPTIONS IN ADDITION TO STANDARD

The cost of the following requested options is included in our bid price:

- \*\*\*\* The cost of the Grove air horns are included in the chassis price.  
Grover air horns shall be activated in one of three manners:
1. Freightliner OEM lanyard
  2. Three way switch located in cab console. Forward position - siren, center position - air horn and rear position - chassis horns.
  3. Spring loaded momentary switch located in dash area passenger side. Switch to be labeled AIR HORNS. **Refer to enclosed photo of dash area for exact location.** \$ 25.00
- \*\*\*\* Chassis exhaust system to accommodate Plymovent exhaust system. Exhaust pipe to be located on right side of vehicle in front of rear dual tires. Refer to photos. \$ 30.00
- \*\*\*\* Rear bumper center fold-up section to have ball and socket style lock system so that fold up section can be secured in the up position while loading cot. N/C
- 0830 Install rubber dock bumpers on rear bumper end pods. \$ 55.00
- \*\*\*\* Medtec to design and build custom floor mounted console. Console to have the capability of housing two customer supplied VHF radio and customer supplied portable radio charges in front portion. Center portion of console to have storage area for five (5) 3 ring notebooks and will have four (4) adjustable dividers. Rear section will have an enclosed area for the storage of disposable gloves. Exact design of console will depend on your choice of transmission. \$ 250.00
- 4720 Install 12 volt power lead which should be hot all of the time. Lead to run to front area of floor mounted console and will be used to power the two (2) customer supplied portable radio chargers. \$ 25.00
- \*\*\*\* Install one (1) dump valve cancel switch to over ride air ride system. Switch to be located just inside of right rear patient entrance door. Refer to prints. \$ 55.00
- 3650 Foster Coach to install park over-ride switch having automatic reset feature. When transmission is placed in PARK position, the following emergency lights will deactivate and will reactivate when system is returned to drive position: **Front light bar except for lower deck red and green flashing halogen lights, rear light bar, grill lights and side intersection lights.** Medtec to leave top row, left position in switching panel open. \$ 95.00

8/1/01

Page 2

## Downers Grove - options

2360	Install ETI ignition security system.	\$ 95.00
2450	Install Kussmaul Series 4000 #091-89-12 45 amp battery conditioner. Remote indicator gauge to be mounted next to battery switch located at base of driver's seat.	\$ 795.00
3690	Install Southern #SA-441 Magnum siren with speakers wired separately. (ILOS)	\$ 75.00
****	Siren, air horn system and chassis electric horns shall operate through a three-way switch located in cab console. Forward position is siren, center is air horns, rear is chassis horns. Whichever switch position is selected, that audible signal will be activated through the chassis steering wheel horn pad.	\$ 60.00
****	Install one (1) spring loaded style switch in cab console labeled AIR HORN.	\$ 50.00
2440	Install Cole Hersee #M-2484 on/off battery switch mounted on side of driver's seat.	\$ 75.00
1290 & 1300	Modular body to have high expansion spray foam insulation applied to walls, ceiling and under side of floor. (ILOS)	\$ 475.00
1660	Patient entry door kick panels to be stainless steel.	\$ 135.00
1040	Install electrically operated door locks in modular exterior compartment doors and patient entrance doors.	\$ 465.00
1090	Additional door lock switches shall be mounted on wall panels adjacent to curb side and rear patient entrance doors and interior door panel of ALS cabinet. Door lock switch in front console is standard. Refer to prints.	\$ 165.00
1080	Install hidden door lock switch in top portion of rear license plate frame.	\$ 155.00
1110	Wire compartment and patient entry door locks to chassis OEM door lock circuit.	\$ 100.00
2090	Curb side patient entrance door window to have dark privacy glass.	\$ 9.00
2140	Modular rear door windows to have privacy glass.	\$ 15.00
0630	Install hinged vertical divider in Compartment "D-1".	\$ 220.00
0530	Install one (1) adjustable shelf in compartment "D-2". See print.	\$ 210.00

8/1/01

Page 3

## Downer Grove - options

- 0750 Compartment "D-4" to be 65" high x 39" wide. Located on lower back wall mounted to two horizontally mounted Uni-Strut tracks will be a sheet of 1/4" smooth aluminum 24" high x 39" wide having the top and bottom edge rolled over 3/4". **This sheet of aluminum will be used to mount two (2) Scott 4.5 SCBA mounting brackets Ziomatic #KDUH6SFCRS supplied and installed by Foster Coach. In addition Foster Coach will provide and install four (4) coat hooks at time of delivery.**  
Location of hooks to be customer's choice. \$ 650.00
- 1000 Modular interior head room to be 72 inches \$ 605.00
- 0220 Base of street side cabinet to be covered with brushed stainless steel. \$ 325.00
- 0240 Base and end of squad bench to be covered with brushed stainless steel. \$ 160.00
- 5711 Top front and rear cabinet in main cabinet wall and cabinet over squad bench to have hinged flip up cabinet face frames and locks having gas cylinder hold openers to be used for purposes of cleaning and restocking. See prints. \$ 450.00
- \*\*\*\* Located on front wall cabinet between left side wall of ALS cabinet and electrical cabinet will be a semi triangular shaped desk which will incorporate a storage drawer. See drawing. \$ 450.00
- 5622 Medtec to install #MVP **non-fold down** arm rest and oxygen storage cabinet for two (2) "D" or "E" size tanks at head end of squad bench. See print. \$ 128.00
- \*\*\*\* Front ALS cabinet design to be as follows: Lower portion of cabinet to have ROM aluminum roll-up door, center section to have 5" working depth, locking aluminum drug drawer, top section to have ROM aluminum roll-up door having friction brake style handle. Top portion to also have two (2) adjustable shelves. ROM aluminum door tracking to go across top of cabinet and down back wall. Refer to print. \$ 900.00
- 5860 Install biohazard/sharps waste storage cabinet at head, aisle end of squad bench. Exact height and width of cabinet will be provided at a later date. \$ 120.00
- 5860 Install biohazard/sharps waste storage cabinet under second action area. Door to be 15" wide x 18" tall. \$ 120.00
- 5760 OEM suction aspirator canister and vacuum outlet to be located in slide out drawer in cabinet below first action area. \$ 145.00
- 4841 OEM suction aspirator system to operate through SSCOR control panel on back wall of main action area. \$ 80.00
- \*\*\*\* Captain style attendant seat to have seat belt with 3 point shoulder safety harness. \$ 175.00

8/1/01

Page 4

## Downers Grove - options

4640 & 4580	Install electrically controlled oxygen system having manual bypass valve. This system shall also include a digital oxygen contents gauge with a 500 PSI low pressure alarm	\$ 494.00
4340	Install ( 1 ) additional (Ohio brand) oxygen outlet located over squad bench.	\$ 180.00
4340	Install ( 1 ) additional (Ohio brand) oxygen outlet located in ceiling over main cot.	\$ 180.00
****	<b>Foster Coach to provide and ship with vehicle one (1) Ferno Washington #93ES cot.</b>	\$ 2,370.00
2520	Install auxiliary modular A/C condensing unit located on under side of vehicle.	\$ 800.00
2501	Install digital style module body thermostat. (Hoseline #CM1000)	\$ 188.00
2951	Install super duty Kussmaul 20 amp auto-eject shoreline inlet having a <b>red face plate</b> and pigtail located on left rear of module body. See print.	\$ 225.00
2880	Install ( 1 ) additional 115 volt duplex outlet located on front bulk head wall under desk. See print.	\$ 63.00
4700	Install one (1) additional 12 volt cigarette style outlet on front bulk head wall underneath desk.	\$ 45.00
****	Install second modular disconnect switch located in rear attendant console. Switch is to be wired in a 3-way circuit so that no matter what switch is activated, the module will be activated.	\$ 70.00
2270	Franklin 12/24 hour 9" clock installed in head cushion pad over rear door.	\$ 120.00
5892	Install two (2) glove box holders recessed into the head pad over curb side door with single fold-down Plexiglas restocking door.	\$ 150.00
5893	Install two (2) glove box holders recessed into the head pad over the rear patient doors.	\$ 150.00
6026	All sliding or hinged Plexiglas doors to have full length aluminum extruded pull handles with the ends cut at <b>45 degree angle</b> .	\$ 25.00
****	Medtec's standard installed radio antenna lead to terminate underneath custom cab console. Antenna lead is for UHF frequency. This lead should run to front, center antenna mount on roof.	Standard
2310	Install ( 1 ) antenna base and coaxial cable to terminate underneath custom cab console. Antenna lead to be VHF frequency and shall be located front, second center on roof.	\$ 55.00

8/1/01

Page 5

## Downers Grove - options

2310	Install one (1) antenna base and coaxial cable to terminate behind switching panel in rear attendant console. Antenna lead to be a VHF frequency and shall be located third center on roof.	N/C
2320	Install cellular phone antenna and coaxial cable. Antenna lead to terminate underneath desk on front wall bulkhead. Antenna to pass thru decorative stainless steel face plate.	\$ 65.00
2310	Provide 6" high x 9" wide 1/4" black ABS radio head mounting bezel in rear action area.	\$ 40.00
1940	Install 2" ID flexible PVC conduit running from behind passenger seat in cab to behind action wall in modular. This conduit is used for the installation of two-way radio equipment, cables and future computer cables.	\$ 85.00
1551	Install Whelen 9E series back up, brake and directional lights having amber turn arrow, all lights to have flanges.	\$ 280.00
3615	Exterior compartment doors to activate appropriate side scene light.	\$ 45.00
3610	Curbside scene lights to be curbside door activated.	\$ 45.00
3600	Rear side scene lights to be reversed activated.	\$ 45.00
3570	All Whelen standard scene lights to have flanges.	\$ 80.00
4070	Install two (2) Whelen #9E red strobe lights located on rear of module so that they may be seen through rear door windows when open. See print.	\$ 256.00
3930	Install Whelen #UPS64LX strobe power supply wired to the two #9E warning lights on rear of module and the two strobe lights located in the Whelen Advantedge 5000 series rear light bar.	\$ 330.00
3950	Install Whelen #UPS188 eight (8) head strobe power supply to be wired to the two grill lights, front intersection lights and rear intersection lights.	\$ 712.00
4030	Located on rear of module below strobe lights will be two (2) Whelen 9E red halogen lights with flanges. Lights to have alternating flash pattern. See print.	\$ 166.00
4140	Wire above Whelen lights to brake light circuit.	\$ 45.00
3980	All Whelen standard warning lights to have flanges.	\$ 120.00
3830	Install Whelen 7E series strobe grill lights having red lens on left side and green lens on right side. (ILOS)	\$ 113.00
3110	Install Road Runner wig wag headlight system.	\$ 80.00

8/1/01

Page 6

## Downers Grove - options

- 3250 Install Whelen MC front fender intersection strobe lights having red/clear split lenses. (ILOS) (Stacy, these lights must be equal to the Whelen 73 series, TS200 twin strobe lights.) \$ 295.00
- 4060 Install over rear wheel well housing Whelen 7E series red strobe rear intersection lights. \$ 246.00
- 4020 Install on each side at rear Whelen 7E series red warning light with integrated flanges. This light will serve as a steady burn DOT light and will flash with turn signals. (ILOS) \$ 120.00
- \*\*\*\* Delete standard Code 3 front light bar and install a Federal Vista 62" long light bar. Refer to enclosed drawing showing light bar. This light bar shall be wired to a 3-way switch: forward position - all on, center position - off, rear position - only top deck left and right side rotators to operate. \$ 866.00
- \*\*\*\* Install Whelen Advantedge #5000-KKKRS rear light bar. Light bar to have two (2) rotators, two (2) strobes and three (3) halogen warning lights and two (2) loading lights. Lens colors to be determined. \$ 963.00
- \*\*\*\* Located on rear of module below rear light bar will be a Federal Signal Master #SIGM8-30 Arrow Stik light bar. Light bar will be controlled by a #SMC3 control head. **This warning light is to be ignition or battery hot all of the time. This means that the lights should be able to be operated without the emergency Mater Switch being in the on position. Any questions, contact me.** \$ 473.00
- \*\*\*\* Install one (1) Questar cab roof mounted spot light. Light to be installed in center of cab roof. \$ 360.00
- 3400 Install customer supplied 3M opticom admitter light which shall be **center mounted inside** of the front light bar. Admitter light to deactivate when transmission is placed in PARK. \$ 155.00
- 4180 Install two (2) additional ceiling dome lights in headliner of module. Refer to print. \$ 110.00
- 4230 Install three (3) 39" 12/115 volt Thinlight fluorescent light fixtures in ceiling of module. \$ 555.00
- 4265 Install 5-60 minute rotary timer wired to fluorescent lights in ceiling. Timer to be located on squad bench wall just inside curb side door. See Print. \$ 75.00
- 4310 Install SignalStat recessed stepwell light. \$ 35.00
- 0360 Chassis will be ordered from Freightliner painted red to match the existing red color used by your department. Medtec will then repaint the chassis red #71663 and roof of cab black. This is being done to assure that chassis and module body match. \$1,400.00

8/1/01

Page 7

## Downers Grove - options

- 0330 Module body will be painted red #71663. Roof and approximately 12" down on side of module will be painted black. The break line between red and black on module body will be in line with the black on the chassis cab roof. \$ 600.00
- 0470 Medtec will install a 9" wide black 3M reflective Scotchlite beltline stripe running down both sides of vehicle and across back. \$ 945.00
- \*\*\*\* Foster Coach will make arrangements with Signwise, Inc. of Lombard, Illinois to have vehicle lettered. Lettering to be per enclosed quotation from Signwise, Inc. \$ 625.00
- 6150 Install seat belt assembly on rear wall for forward facing child safety seat. \$ 45.00
- \*\*\*\* Foster Coach to provide miscellaneous hardware kit consisting of stainless steel nuts, bolts, screws, etc. plus one (1) can of ECK electrolysis corrosion control compound. This product is used by Medtec in constructing their vehicles. \$ 60.00
- 0040 One (1) additional set of Medtec operator manuals. \$ 30.00
- 4420 Install 18" Thinlight fluorescent light in second action area. \$ 45.00
- 4420 Install 18" Thinlight fluorescent light above desk on front wall. Refer to print. \$ 45.00
- 0140 Flooring to be Loncoine black onyx \$ 75.00
- 2980 Install two (2) stereo am/fm radio speakers in ceiling of module having volume control switch. Switch to be located in attendant's console. \$ 118.00
- \*\*\*\* Install a ball and socket style device to hold the fold-up center section of the rear bumper assembly in the up position if necessary. N/C

# Business Class Trucks

Prepared for Foster Coach Sales, Inc.  
1231 W. Fourth St.  
P.O. Box 700  
Sterling, IL 61061-0700  
(815)625-3276  
Steve Foster

Prepared by Truck Country Rockford  
3814 - 11th Street

61109  
Kevin Wall  
Quote ID: Downers03  
July 31, 2001

**Your Price F.O.B. Sterling:**

**\$50,495.00**

Option - Overhead storage compartment:

\$580.00



The company that does things right.

# Business Class Trucks

Prepared for Foster Coach Sales, Inc.  
 1231 W. Fourth St.  
 P.O. Box 700  
 Sterling, IL 61061-0700  
 (815)625-3276  
 Steve Foster

Prepared by Truck Country Rockford  
 3814 - 11th Street

61109  
 Kevin Watt  
 Quote ID: DownersG3  
 July 31, 2001

## SPECIFICATION PROPOSAL

SpecPro Version: V3.50

Data Book Code	Specifications	Weight (+/-) Front	Weight (+/-) Rear	Sugg. Retail Price (\$)
<b>MODEL</b>				
001-045	FL50 MODEL	5050	2850	61,163.00
002-004	SET-BACK AXLE TRUCK PACKAGE			STD
019-002	STRAIGHT TRUCK PROVISION			STD
003-001	PRIMARY STEERING LOCATION: LEFT-HAND			STD
<b>GENERAL SERVICE</b>				
AA1-002	TRUCK CONFIGURATION			STD
A85-006	RESCUE & EMERGENCY SERVICE			N/C
AA3-024	AMBULANCE BODY			N/C
AA4-011	FIXED LOAD COMMODITY			N/C
AA5-002	100% ON HIGHWAY/CITY TERRAIN			STD
AB5-001	SMOOTH CONCRETE OR ASPHALT ROAD SURFACE			STD
AB1-008	MAXIMUM 8% EXPECTED GRADE			STD
AA6-002	DOMICILED, USA 49 STATES			N/C
995-006	BASIC VEHICLE WARRANTY			STD
A66-99D	EXPECTED FRONT AXLE LOAD	7000	LBS	
A68-99D	EXPECTED REAR AXLE LOAD	10000	LBS	
A63-99D	EXPECTED GVW CAPACITY	17000	LBS	
<b>TRUCK SERVICE</b>				
A88-99D	TRUCK BODY LENGTH	22	FT	
A89-99D	CAB TO TRUCKBODY CLEAR	4	IN	
<b>ENGINE</b>				
101-1RT	CUM ISB-225 225 HP @ 2300 RPM; 2500 GOV RPM 520 LB/FT @ 1600 RPM 98 EPA/CARB	30		2,228.00
<b>ELECTRONIC ENGINE CONTROL</b>				
ED2-99D	ROAD SPEED LIMIT M/KPH	70	MPH	
<b>ENGINE EQUIPMENT</b>				
105-001	OIL CHECK & FILL: ENGINE MOUNTED			STD
014-008	AIR INTAKE: FRONTAL WITH RAIL MOUNTED DONALDSON AIR CLEANER			STD
190-001	AIR CLEANER: DONALDSON ONE-STAGE			STD
124-040	ALTERNATOR: 270 AMP LEECE NEVILLE 4864 W/AC TAPS & SMARTCHECK LED DIAGNOSTICS	20		1,241.00



The company that does things right.

# Business Class Trucks

Prepared for Foster Coach Sales, Inc.  
1231 W. Fourth St.  
P.O. Box 700  
Sterling, IL 61061-0700  
(815)625-3276  
Steve Foster

Prepared by Truck Country Rockford  
3814 - 11th Street

61109  
Kevin Watt  
Quote ID: DownersG3  
July 31, 2001

Data Book Code	Specifications	Weight (+/-) Front	Weight (+/-) Rear	Sugg. Retail Price (\$)
* 292-029	(3) DELCO 31-900 12V MF 2700 CCA BATTERIES WITH THREADED TOP POSTS	40	40	383.00
290-017	BATTERY BOX: FRAME MOUNTED			STD
180-998	CLUTCH: NONE			N/C
107-007	COMPRESSOR: CUMMINS 15.2 CFM			N/C
131-002	DISCHARGE LINE: TEFLON			N/C
152-040	ENGINE PROTECTION: ELECTRONIC ENGINE-INTEGRAL WARNING SYSTEM & DERATE			N/C
* 128-028	ENGINE BRAKE: PACBRAKE EXHAUST W/BRAKE PEDAL ACTIVATION REFER TO SERIAL NUMBER H10033	12		1,425.00
* 016-013	EXHAUST: SINGLE RH MID HORIZ MUFFLER & HORIZ TAILPIPE REFER TO SERIAL NUMBER H10033			
273-018	FAN DRIVE: HORTON DRIVEMASTER ON/OFF			406.00
110-003	FUEL FILTER: CUM SPIN ON			N/C
118-001	FULL FLOW OIL FILTER			STD
*N 120-009	COOLANT FILTER: FLEETGUARD			
266-030	RADIATOR: 720 SQ IN ALUMINUM			STD
103-036	HEAVY DUTY COOLANT: ETHYLENE GLYCOL PRE CHARGED SCA TO -30F			STD
* 171-002	COOLANT HOSE: SILICONE HOSES WHERE POSSIBLE			360.00
172-001	HOSE CLAMPS: CONSTANT TENSION FOR COOLANT HOSES 1" INSIDE DIAMETER 7 GRTR			STD
138-010	ENGINE HEATER: PHILLIPS 750 WATT/115V	5		93.00
134-001	FLYWHEEL HOUSING: ALUMINUM			STD
132-001	AIR INTAKE WARMER			N/C
155-016	STARTER: DELCO 12V 28 MT			STD
<b>TRANSMISSION AND EQUIPMENT</b>				
342-1AY	TRANSMISSION: ALLISON 1000 SERIES AUTOMATIC			STD
343-069	5-SPD FIVE AND EMERGENCY 1000/2000/2400 5/4/2/1 SELECTOR TRANS PROGRAMMING			N/C
341-018	MAGNETIC ENGINE DRAIN, & R AXLE FILL & DRAIN PLUGS			STD
345-036	SHIFT LEVER: T-HANDLE CABLE SHIFT CONTR W/PARK POSITION FOR INTERNAL PARK PAWL			N/C
370-015	TRANSMISSION OIL COOLER: WATER TO OIL			STD
<b>FRONT AXLE AND SUSPENSION</b>				
400-029	FRONT AXLE: MERITOR FC-941 @ 8000#			STD
402-015	FRONT BRAKES: BOSCH HYDRAULIC DISC			STD



The company that does things right.

3

# Business Class Trucks

Prepared for Foster Coach Sales, Inc.  
 1231 W. Fourth St.  
 P.O. Box 700  
 Sterling, IL 61061-0700  
 (815)625-3276  
 Steve Foster

Prepared by Truck Country Rockford  
 3814 - 11th Street

61109  
 Kevin Watt  
 Quote ID: DownersG3  
 July 31, 2001

Dmn Book Code	Specifications	Weight (+/-) Front	Weight (+/-) Rear	Sugg. Retail Price (\$)
403-026	FRONT BRAKE LININGS: NON-ASBESTOS FIRE & EMERGENCY SEVERE SERVICE			N/C
419-004	FRONT DISC BRAKE ROTORS			STD
427-001	FRONT BRAKE DUST SHIELDS			STD
409-002	FRONT OIL SEALS: CHICAGO RAWHIDE			STD
408-001	FRONT HUB CAP: VENTED - OIL			STD
536-010	POWER STEERING: TRW TAS40 FRAME MOUNTED 8000# MAX FRONT AXLE RATING			STD
539-003	POWER STEERING PUMP:			STD
534-001	POWER STEERING RESERVOIR: 2 QUART			STD
620-032	FRONT SUSP: TAPER LEAF 8000#	20		19.00
619-005	SPRING PIN BUSHINGS: MAINTENANCE FREE RUBBER BUSHINGS			STD
410-001	FRONT SHOCK ABSORBERS			STD
<b>REAR AXLE AND SUSPENSION</b>				
420-126	REAR AXLE: MERITOR RS-13-120 F-SERIES 13000#			STD
421-358	3.58 REAR AXLE RATIO			N/C
424-001	REAR AXLE CARRIER HOUSING: IRON			STD
386-054	MAIN DRIVELINE: DANA SPICER SPL70 W/ HALF ROUND YOKES			STD
423-015	REAR BRAKES: BOSCH HYDRAULIC DISC			STD
433-025	REAR BRAKE LININGS: FIRE & EMERGENCY SEVERE SERVICE NON-ASBESTOS			25.00
451-005	REAR DISC BRAKE ROTORS: HYDRAULIC BRAKE			STD
425-002	REAR BRAKE DUST SHIELDS			N/C
440-001	REAR AXLE OIL SEALS: CHICAGO RAWHIDE			STD
* 435-010	TRANSMISSION MOUNTED AIR OPERATED PARKBRAKE			249.00
622-1CW	REAR SUSP: 10000# AIRLINER		-50	457.00
621-047	REAR SUSP RIDE HEIGHT: LOW			N/C
431-001	AXLE CLAMP: STANDARD U-BOLT			STD
* 888-006	AIR SUSP DUMP VALVE: MANUAL DUMP VALVE W/INDICATOR LIGHT, GAUGE & BUZZER REFER TO SERIAL NUMBER H10033 FOR GAUGE	10		173.00
910-002	REAR SUSP CHASSIS AIR PIPING: DUAL INSTANT RESPONSE REAR SUSP LEVELING VLV			215.00
439-004	SHOCK ABSORBER: ONE AXLE			N/C
<b>BRAKE SYSTEM EQUIPMENT</b>				
018-003	BRAKE PACKAGE: BOSCH HYDRAULIC BRAKE W/ AIR SUPPLY SYSTEM	50	20	1,041.00
490-032	ANTI-LOCK BRAKING SYSTEM: HYDRAULIC WABCO			STD



The company that does things right.

# Business Class Trucks

Prepared for Foster Coach Sales, Inc.  
 1231 W. Fourth St.  
 P.O. Box 700  
 Sterling, IL 61061-0700  
 (815)625-3276  
 Steve Foster

Prepared by Truck Country Rockford  
 3814 - 11th Street

61109  
 Kevin Watt  
 Quote ID: DownersG3  
 July 31, 2001

Data Book Code	Specifications	Weight (+/-) Front	Weight (+/-) Rear	Orig. Retail Price (\$)
871-011	CHASSIS AIR LINES: HYDRAULIC TUBING & REINFORCED NYLON, FABRIC/WIRE BRAID CILA			N/C
* 480-021	AIR DRYER: BENDIX AD-9 WITH HEATER MOUNTED UNDER CAB	40		557.00
460-011	AIR RESERVOIRS: ONE STEEL AIR RESERVOIR W/CHECK VALVE			N/C
477-005	AIR TANK DRAIN VALVES: BERG AUTO DRAIN VALVE WET TANK			N/C
<b>WHEELBASE</b>				
* 545-432	170"/4325MM WHEELBASE			
<b>FRAME</b>				
546-020	FRAME: 1/4" X 3" X 10"..... (6.35MM X 75.85MM X 254MM) STEEL	120		73.00
565-001	REAR SUSP CROSSMEMBER: STANDARD			STD
572-001	REAR MOST CROSSMEMBER			STD
553-001	END FRAME: SQUARE			STD
<b>CHASSIS EQUIPMENT</b>				
556-096	BUMPER: 12" CHROMED THREE PIECE STEEL W/COLLAPSIBLE BOXED ENDS			333.00
558-001	FRONT TOW HOOKS: (2) FRONT FRAME MTD	10		93.00
574-003	LICENSE PLATE MOUNTING: SINGLE LICENSE PLATE BRACKET BELOW BUMPER			STD
*N 510-925	(1) GOODYEAR G159.....245/70R 19.5 14 PLY & 19.5 x 6.75 ALU ALCOA HP8 DISC WHL			450.00
<b>FUEL TANKS AND EQUIPMENT</b>				
* 206-028	50 GAL / 189 LITER RECTANGULAR STEEL FUEL TANK - RH	15	15	123.00
204-998	LH FUEL TANK: NONE			STD
218-005	FUEL TANK: RECTANGULAR			STD
215-005	FUEL TANK & BAND FINISH: PLAIN TANK W/PAINTED BANDS			STD
212-007	FUEL TANK LOCATION: FORWARD			STD
205-001	FUEL TANK CAP:			STD
122-017	F/W SEPARATOR: RACOR #325R W/HEAT ELEM W/DASH MTD WATER SENSOR LIGHT	15		281.00
216-020	FUEL SYSTEM: F/L EQUIFLO INBOARD			STD
202-003	FUEL HOSE: NYLON			N/C
<b>FRONT TIRES, HUBS, WHEELS</b>				
093-953	GOODYEAR G159.....245/70R 19.5 14 PLY	-80		234.00
418-001	FRONT HUBS: GUNITE IRON			STD



The company that does things right.

# Business Class Trucks

Prepared for Foster Coach Sales, Inc.  
1231 W. Fourth St.  
P.O. Box 700  
Sterling, IL 61061-0700  
(815)625-3276  
Steve Foster

Prepared by Truck Country Rockford  
3814 - 11th Street

61109  
Kevin Watt  
Quota ID: DownersG3  
July 31, 2001

Data Book Code	Specifications	Weight (+/-) Front	Weight (+/-) Rear	Sugg. Retail Price (\$)
502-313	19.5 X 6.75 FRT ALU ALCOA HP8 DISC WHLS PART NUMBER 764480	-90		468.00
524-001	POLISHING: FRONT WHEELS (OUTSIDE ONLY)			68.00
	<b>REAR DRIVE TIRES, HUBS, WHEELS</b>			
094-953	GOODYEAR G159.....245/70R 19.5 14 PLY		-160	468.00
450-002	REAR HUBS: GUNITE IRON			STD
505-469	19.5 X 6.75 RR ALU ALCOA HP8/STL ACCU HP8 PART NUMBER 764480/28680		-132	472.00
525-001	POLISHING: REAR WHEELS (OUTSIDE ONLY)			136.00
	<b>CAB EXTERIOR</b>			
829-010	CAB: 106" BBC STEEL CONVENTIONAL			STD
650-027	CAB MOUNTS: HYTEC	15		N/C
678-012	GRAB HANDLES: HANSEN EXTERIOR EXTENDED WITH INSERTS	8		215.00
646-009	GRILLE: PAINTED HOOD MOUNTED			STD
644-004	HOOD: 1-PIECE MOLDED FIBERGLASS HOOD & FENDERS			STD
727-042	AIR HORN: DUAL 25" GROVER LONG STUTTER TONE HOOD MOUNTED	4		247.00
726-002	ELECTRIC HORN: DUAL			13.00
728-002	HORN SHIELD: DUAL			38.00
* 657-003	KEY & LOCKSET: ALL UNITS TO BE KEYED ALIKE REFER TO SERIAL NUMBER #10033			34.00
312-007	HEADLIGHTS: SINGLE RECTANGULAR HALOGEN			N/C
302-001	MARKER LIGHTS: (5) SMALL			STD
294-001	STOP/TAIL/TURN LIGHTS: W/BACKUP LAMPS AT END OF FRAME			STD
300-015	TURN SIGNAL: FRONT LAMPS			STD
744-029	PRIMARY MIRRORS: S/S MOTO HD MIRRORS: L&R REMOTE HEATED WIRED THRU IGNITION	4		739.00
797-001	DOOR MOUNTING OF MIRRORS			STD
796-002	EQUIPMENT WIDTH: 96" FOR MIRRORS			STD
743-202	AUXILIARY MIRRORS: LH 6"/RH 6" CONVEX BRIGHT FINISH MTD UNDER PRIMARY MIRRORS			42.00
74A-001	DOWN VIEW MIRROR: RH			N/C
74B-998	CAB/FENDER MIRRORS: NONE			STD
729-001	SIDE/REAR REFLECTORS:			STD
768-001	REAR WINDOW: 29" X 13" DUAL BOC WINDOWS CLEAR			STD
661-004	DOOR WINDOWS: TINTED W/OPERATING DOOR WING WINDOW			91.00



The company that does things right.

# Business Class Trucks

Prepared for Foster Coach Sales, Inc.  
 1231 W. Fourth St.  
 P.O. Box 700  
 Sterling, IL 61061-0700  
 (815)625-3276  
 Steve Foster

Prepared by Truck Country Rockford  
 3814 - 11th Street

61109  
 Kevin Watt  
 Quote ID: Downer033  
 July 31, 2001

Data Book Code	Specifications	Weight (-/+) Front	Weight (-/+) Rear	SUGG Retail Price (\$)
654-011	DOOR WINDOW REGULATORS: LH & RH ELECTRIC			521.00
663-013	WINDSHIELD: TINTED			N/C
659-004	WINDSHIELD WASHER RESERVOIR: 2-1/2 GAL.			STD
996-001	CERTIFICATION/COMPLIANCE: USA			N/C
<b>CAB INTERIOR</b>				
707-034	INTERIOR: DELUXE GRAY VINYL & CLOTH			361.00
706-018	LH UPPER DOOR TRIM: GRAY VINYL/CLOTH			N/C
708-018	RH UPPER DOOR TRIM: GRAY VINYL/CLOTH			N/C
772-006	FLOOR MATS: BLACK W/SINGLE INSULATION			STD
742-008	CUP HOLDER: ON DASH LEFT HAND SIDE			STD
700-002	HEATER AND DEFROSTER: W/AIR CONDITIONER WITH RECIRCULATION SWITCH	60		924.00
703-005	AIR CONDITIONER CONTROL: W/RECIR SWITCH			N/C
170-015	HEATER PLUMBING			STD
739-013	SILENCER PACKAGE: FOR CAB W/VINYL SNAP-ON SPLASH/DUST COVERS	10		293.00
285-001	ELECTRICAL: AUTOMATIC SELF-RESET CIRCUIT BREAKERS			25.00
280-001	WIRING SCHEMATIC CARD: UNMOUNTED BASIC WIRING DIAGRAM FOR 12V NEG GROUND SYS			STD
324-014	INTERIOR LIGHTS: DOME LIGHT ACTIVATED LH/RH DOORS			N/C
* 655-999	CAB DOOR LATCHES: W/ELECTRIC DOOR LOCKS			350.00
756-081	DRIVER SEAT: BOSTROM TALLADEGA 910 HI BACK	-10		N/C
760-081	PASS SEAT: BOSTROM TALLADEGA 910 HIBACK	50	20	622.00
759-006	ARM REST: DUAL DRIVER; INBOARD PASS SEAT	6		102.00
758-031	DRIVER SEAT COVER: GRAY VINYL W/CLOTH INSERT DRIVER/BENCH			N/C
761-031	PASS SEAT COVER: GRAY VINYL W/CLOTH INSERT			N/C
532-002	STEERING COLUMN: ADJ TELESCOPING TILT	15		420.00
540-006	STEERING WHEEL: 19" 2-SPOKE BLACK CUSHIONED			STD
765-002	INTERIOR SUN VISORS: DRIVER/PASS			STD
<b>INSTRUMENT PANEL AND CONTROLS</b>				
017-076	GAUGE PACKAGE: BUSINESS CLASS GAUGE CLUSTER			STD
732-004	DRIVER INSTRUMENT PANEL: GRAY			STD
486-001	LOW AIR PRESSURE WARNING: LIGHT AND BUZZER			N/C
*N 840-007	AIR SYSTEM PRESSURE GAUGE: SINGLE AIR PRESSURE FOR HYDRAULIC WITH AIR PROV			
* 198-006	AIR RESTRICTION WARNING LIGHT: DASH MID INCLUDE INDICATOR INTAKE MID			79.00



The company that does things right.

# Business Class Trucks

Prepared for Foster Coach Sales, Inc.  
 1231 W. Fourth St.  
 P.O. Box 700  
 Sterling, IL 61061-0700  
 (815)625-3276  
 Steve Foster

Prepared by Truck Country Rockford  
 3814 - 11th Street

61109  
 Kevin Watt  
 Quote ID: DownersG3  
 July 31, 2001

Data Book Code	Specifications	Weight (+/-) Front	Weight (+/-) Rear	Sugg. Retail Price (\$)
149-013	CRUISE CONTROL SWITCHES: IN LH PANEL			STD
156-001	STARTER CONTROL: DASH MOUNTED			STD
811-010	DRIVER INFO CENTER: ODOMETER/VOLTAGAGE DISPLAY IX7 CHIR,26 WARNING LTS,DATA LK			STD
160-012	DIAGNOSTIC INTERFACE CONNECTOR: 9 PIN SAE J1587/1708/1939, LOCATED BELOW DASH			STD
844-001	FUEL LEVEL GAUGE: ELECTRIC			STD
856-001	COOLANT TEMPERATURE GAUGE: ELECTRICAL			STD
864-001	TRANSMISSION TEMPERATURE GAUGE:			STD
882-002	ENGINE OIL PRESSURE GAUGE:			STD
746-067	RADIO: F/U XTA-2100 AM/FM/WB CASSETTE BY DELCO	10		435.00
747-002	RADIO MOUNTING: ROOF/OVERHEAD CONSOLE			N/C
750-002	RADIO SPEAKER: (2) CAB ONLY			N/C
753-001	RADIO ANTENNA: AM/FM ROOF MOUNTED ON FORWARD LEFT HAND			N/C
810-027	SPEEDOMETER: ELECTRONIC MPH W/SECONDARY KPH SCALE, W/O ODOMETER			STD
812-001	TACHOMETER: ELECTRONIC 3000 RPM			STD
482-998	TRACTOR PROTECTION VALVE: NONE			STD
883-998	TRAILER HAND CONTROL BRAKE VALVE: NONE			STD
836-015	DIGITAL VOLTAGE DISPLAY: INTEGRAL WITH DRIVER DIAPLAY			STD
660-008	WINDSHIELD WIFER CONTROL: SINGLE ELECT WIPERS MOTOR W/DELAY			28.00
304-001	MARKER LAMP SWITCH			STD
*N 882-018	ONE VALVE PARK BRAKE SYSTEM W/DASH VALVE/CONT. AUTONEUTRAL & WARNING INDICATOR			266.00
299-009	TURN SIGNAL SWITCH: SELF-CANCELLING W/INTEGRAL HEADLIGHT BEAM 4-WAY FLASHER			STD
298-003	TURN SIGNAL FLASHER: HD MECHANICAL			8.00
<b>PAINT DESIGNS</b>				
065-000	ONE COLOR DESIGN			STD
* 980-SPY	Cab Color A: IMRON M2255HN RED			
986-020	Chassis: BLACK: HIGH SOLIDS POLYURETHANE			
988-001	CUSTOM COLORS			????
<b>ADDITIONAL SPECIFICATIONS</b>				
* 919-014	EXTRA 1730 CU IN AIR TANK WITH CHECK VALVE			175.00
* 238-002	EXHAUST PIPING: FLEXIBLE STAINLESS STEEL			
<b>DEALER OPTIONS</b>				
22222	ONE SET OF SERVICE MANUALS			150.00



The company that does things right.

# Business Class Trucks

Prepared for Foster Coach Sales, Inc.  
 1231 W. Fourth St.  
 P.O. Box 700  
 Sterling, IL 61061-0700  
 (815)625-3276  
 Steve Foster

Prepared by Truck Country Rockford  
 3814 - 11th Street

61109  
 Kevin Walt  
 Quote ID: DownersG3  
 July 31, 2001

Data Book Code	Specifications	Weight (1/-) Front	Weight (1/-) Rear	Sugg. Retail Price (\$)
33333	WIRING DIAGRAMS			
11111	ONE SET OF PARTS MANUALS			150.00
<b>TOTALS</b>		<b>5439</b>	<b>2603</b>	<b>\$ 79,562.00</b>

## TOTAL VEHICLE SUMMARY

**Total Weight**

Front Weight Total.....	5439 LBS
Rear Weight Total.....	2603 LBS
Total Weight.....	8042 LBS

**Total Price**

Suggested Price Total.....	\$79,562.00
Std Destination Charge.....	\$1,300.00
Total Vehicle Price.....	\$80,862.00

(+) Weights shown are estimates only.  
 If weight is critical, contact sales application engineering.



The company that does things right.





NOTES:  
 1) ACTIVATE SCENE LIGHT W/APPROPRIATE COMPARTMENT DOOR.

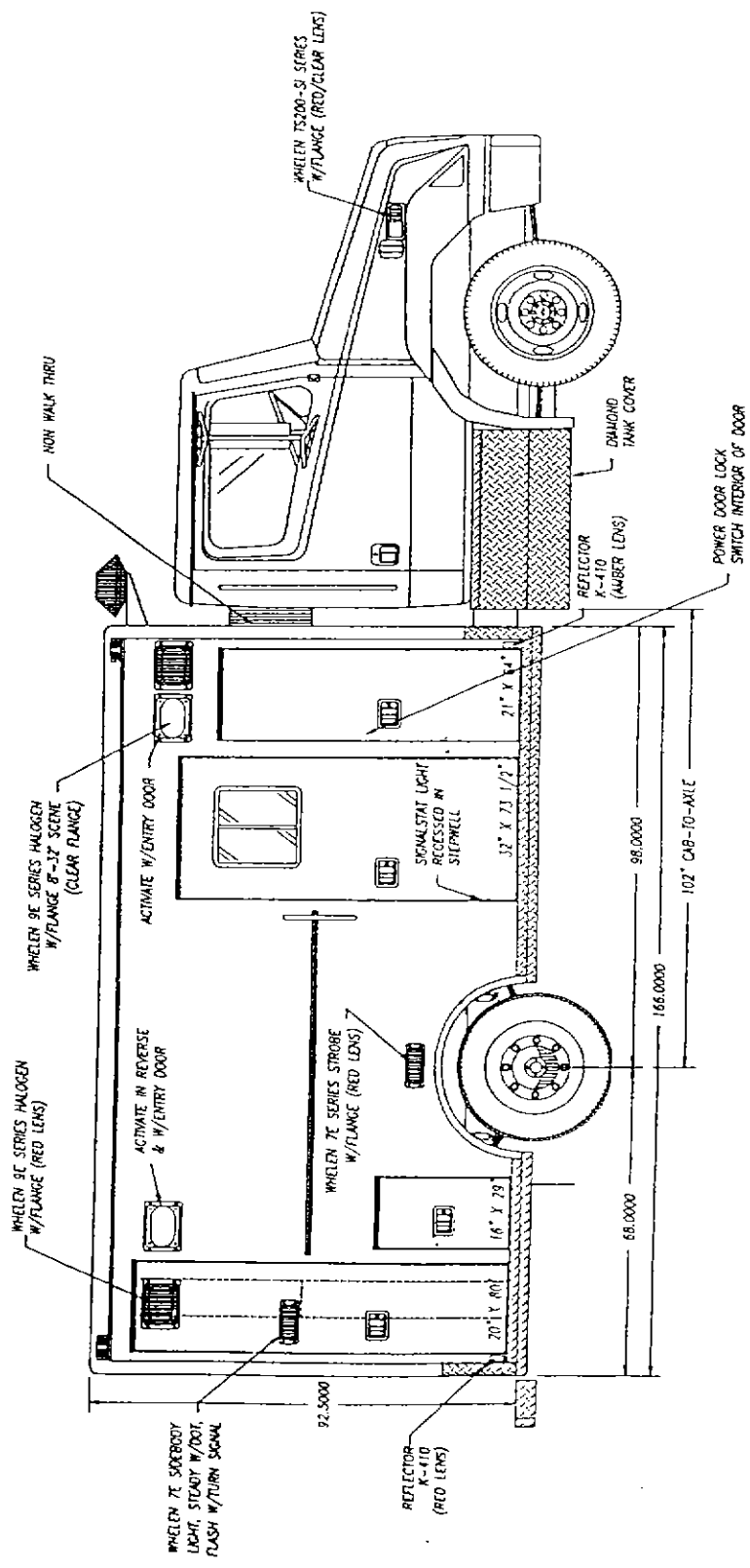

SPECIAL NOTES AND INSTRUCTIONS -

UNIT # 4289

CUSTOMER APPROVAL:

DATE:

DECISIONS SHOWN ARE APPROXIMATE AND ARE SUBJECT TO LABOR DEVIATION AS MAY OCCUR OR BE NECESSARY FOR REPAIRS NOT SHOWN.



DOWNER GROVE F.D.

UNIT NO.	04285-00-3
DATE	1/26/90
BY	J. O. B.
SCALE	AS SHOWN
PROJECT	VOYAGER II-A 166"



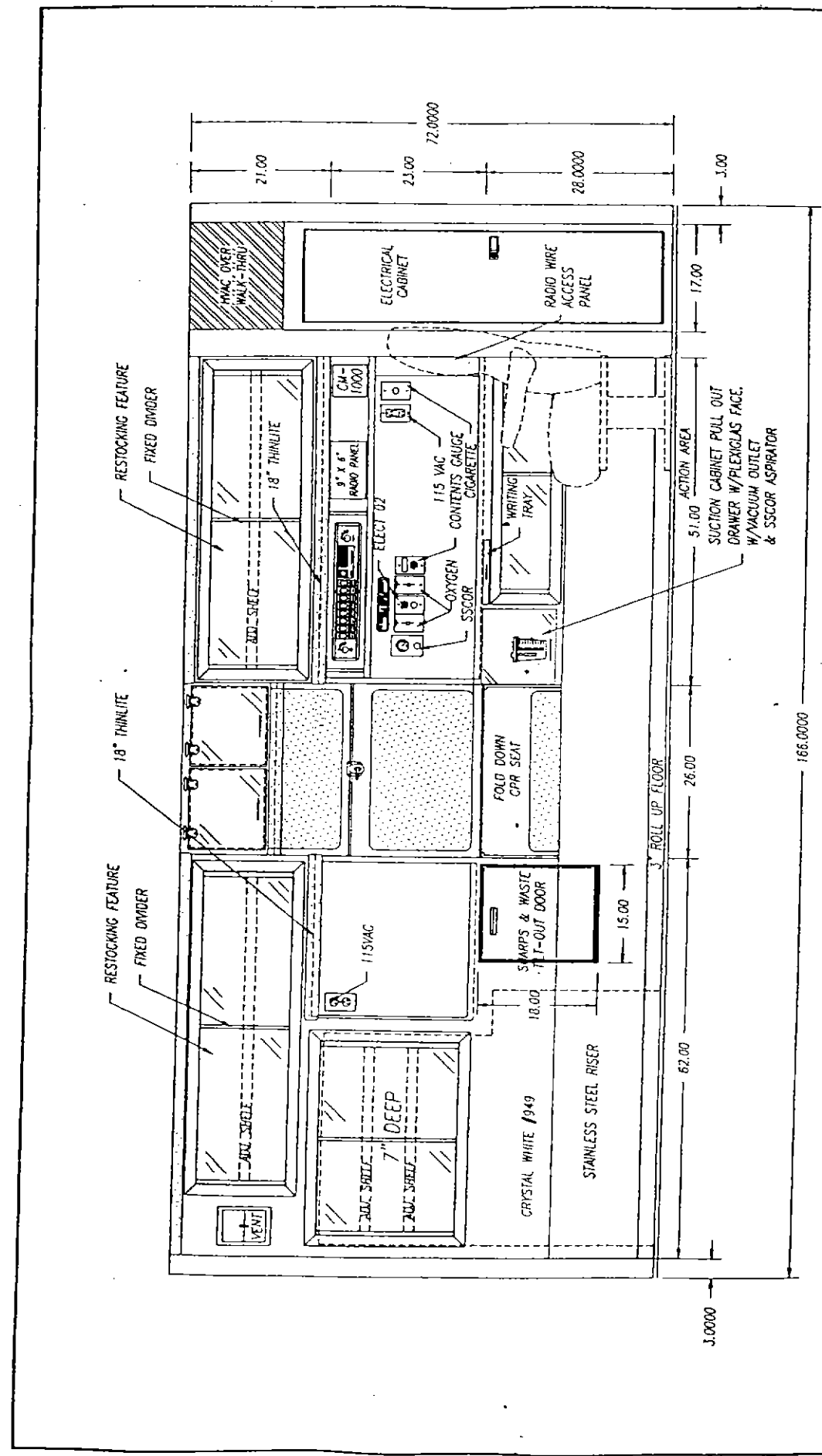

SPECIAL NOTES AND INSTRUCTIONS -

UNIT # 4289

CUSTOMER APPROVAL: \_\_\_\_\_ DATE: \_\_\_\_\_

REV.	BY	DATE	WHAT CHANGED
1	SEE	7/25/00	REVISION BLOCK
2			
3			
4			
5			
6			

MEP/MECH CORPORATION

DIMENSIONS SHOWN ARE APPROXIMATE AND NOT TO SCALE. ALL DIMENSIONS TO BE VERIFIED AS SHOWN ON THE DRAWING. MINOR DETAILS NOT SHOWN.

UNIT - 1/27/00  
 DRAWN BY - SEB  
 CHECKED -  
 SCALE -  
 SHEET NO. - 7 OF 8  
 CUSTOMER - DOWNER GROVE F.D.  
 MODEL - VOYAGER II-A 166"

DATE: 04285-00-7

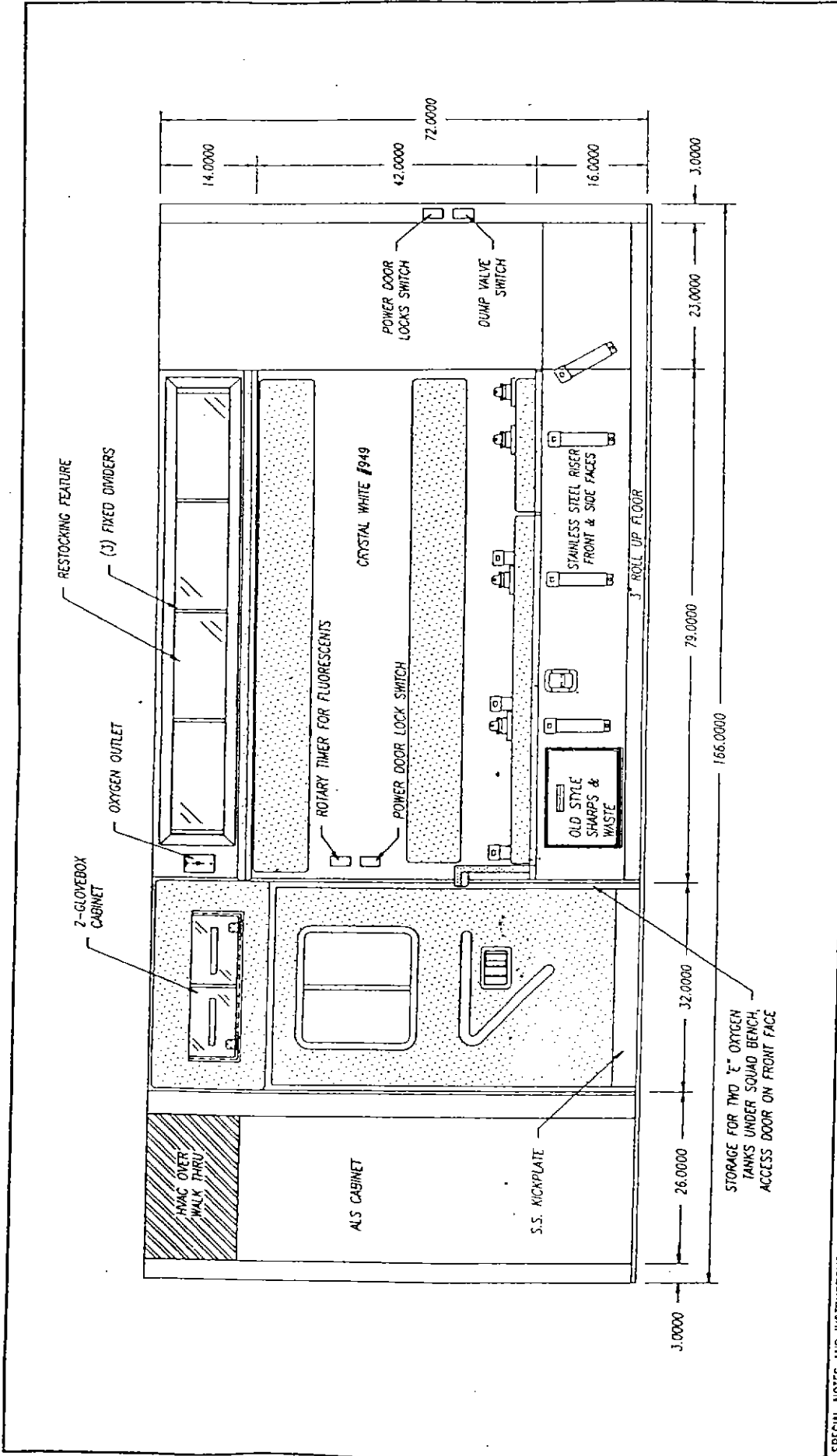

SPECIAL NOTES AND INSTRUCTIONS -		UNIT # 4289		DATE:	
STORAGE FOR TWO 2" OXYGEN TANKS UNDER SQUAD BENCH, ACCESS DOOR ON FRONT FACE		REV. BY DATE: WHAT CHANGED		DRAWINGS SHOW ARE APPROXIMATE AND ARE SUBJECT TO LABOR DIVISION AS MAY OCCUR OR BE NECESSARY IN CONSTRUCTION UNLESS DETAILS NOT SHOWN.	
01	SEB/2/25/00	REVISED	DATE: 1/27/00	SCALE: 1/8" = 1'-0"	PROJECT NO: 8 OF 8
02					
03					
04					
05					
06					
CUSTOMER APPROVAL:			DRAWING NO: 04285-00-8		

DOWNER GROVE F.D.  
 ORDER NO.  
 UNIT # 4289  
 DATE: 1/27/00  
 SCALE: 1/8" = 1'-0"  
 PROJECT NO: 8 OF 8

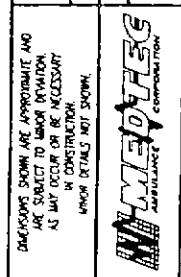

VOYAGER II-A 166"  
 DATE:

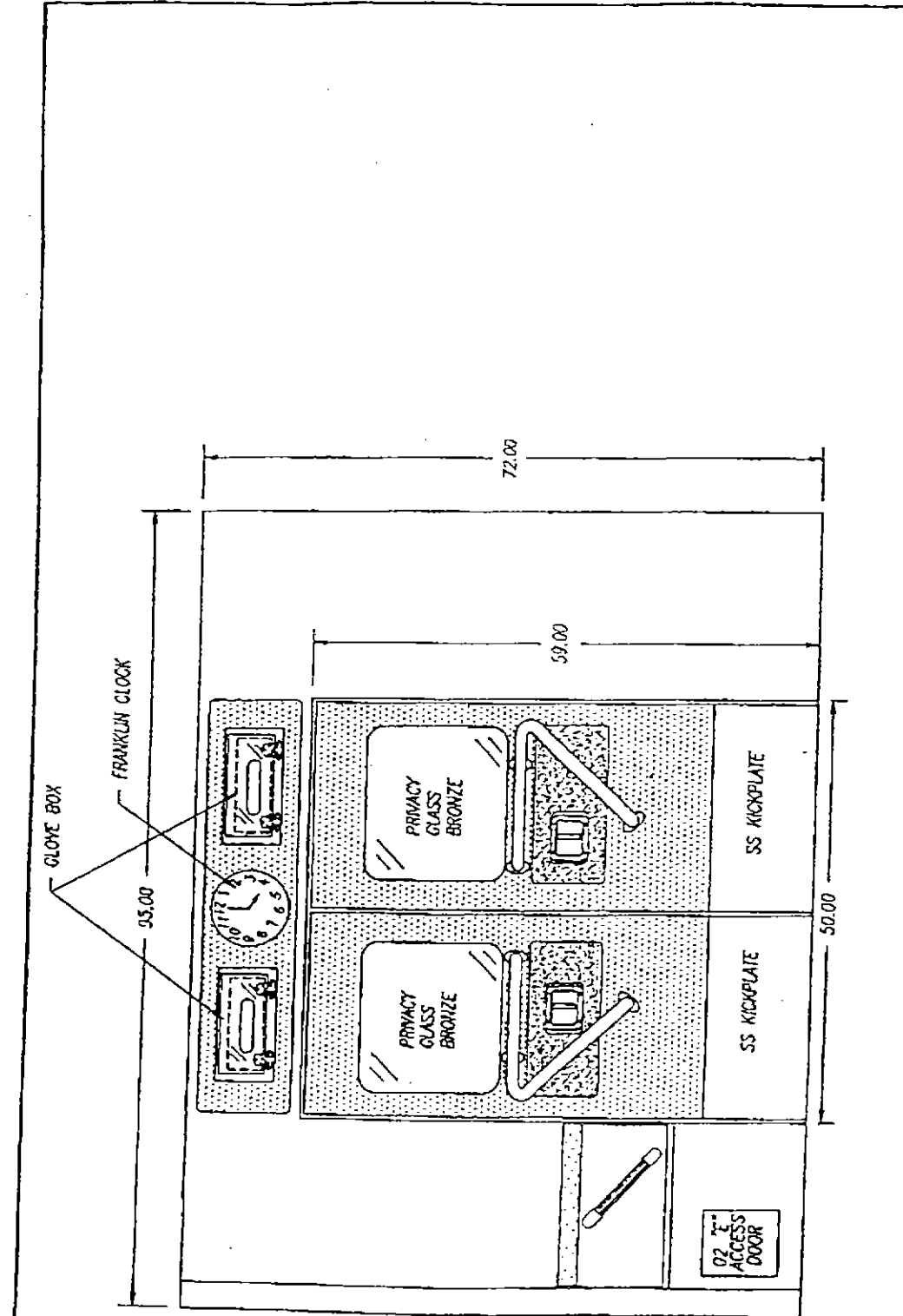

**SPECIAL NOTES AND INSTRUCTIONS -**

**UNIT # 4289**

**CUSTOMER APPROVAL** \_\_\_\_\_ DATE \_\_\_\_\_

**CLIENT - DOWNER GROVE F.D.**

**ORDER # - 328** **DATE - 1/27/20** **UNIT # - 4289** **ROOM # - 77**

**MEP/PLUMBING**

**PROJECT # - D4285-00-9**

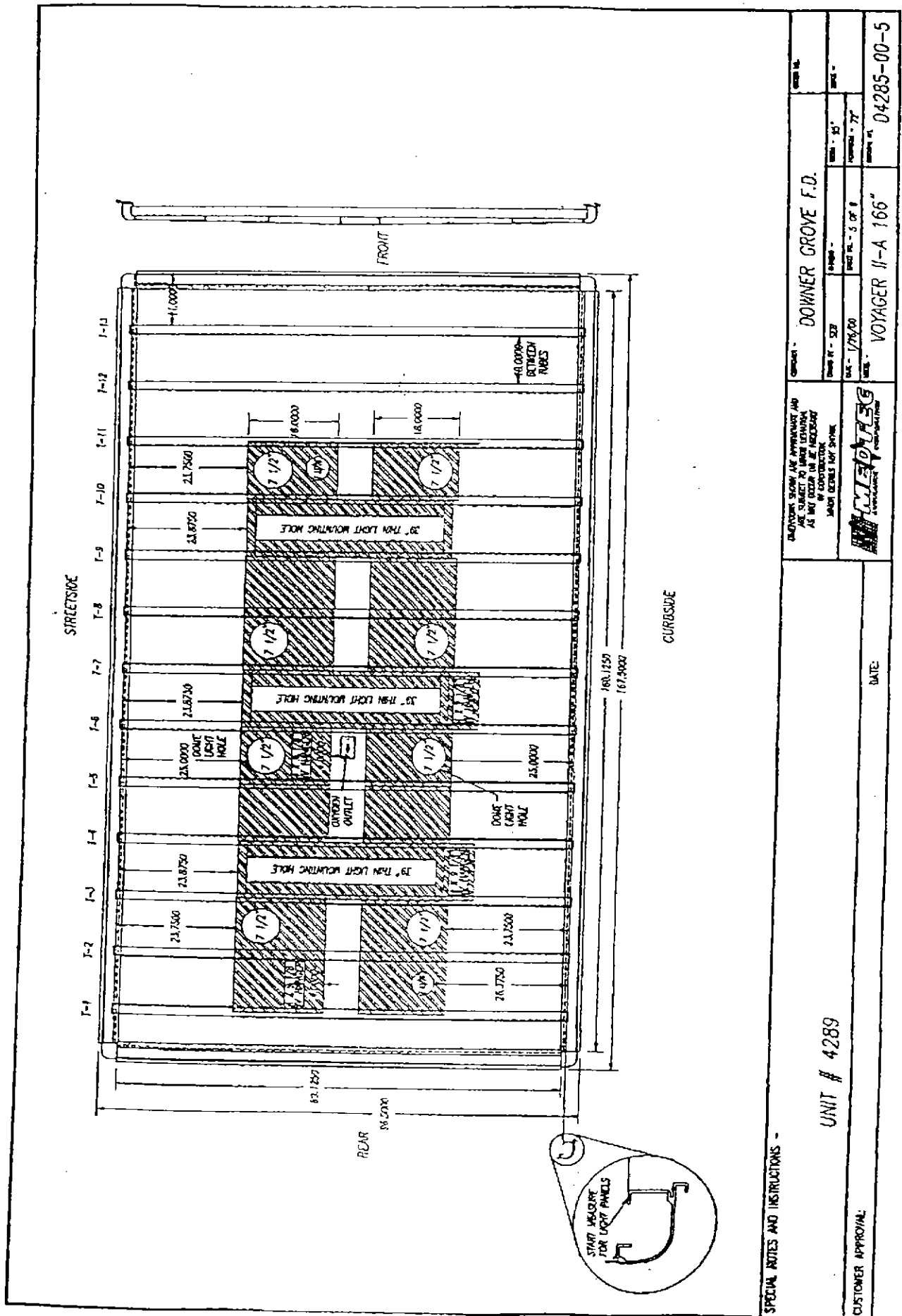

OWNER -		DOWNER GROVE F.D.	
DATE -	1/26/00	SCALE -	1/4" = 1'-0"
PROJECT NO. -	5 OF 8	PROJECT NO. -	04285-00-5

ALL WORK SHOWN AND APPROVED ARE SUBJECT TO LOCAL ORDINANCES AND ALL CITY AND COUNTY ORDINANCES. MANY DETAILS MAY VARY.

**WELDON**  
 WELDON INDUSTRIES  
 A DIVISION OF WELDON INDUSTRIES

SPECIAL NOTES AND INSTRUCTIONS -

UNIT # 4289

CUSTOMER APPROVAL: \_\_\_\_\_ DATE: \_\_\_\_\_

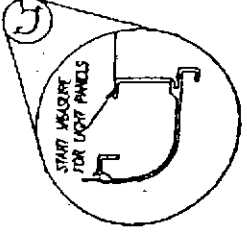

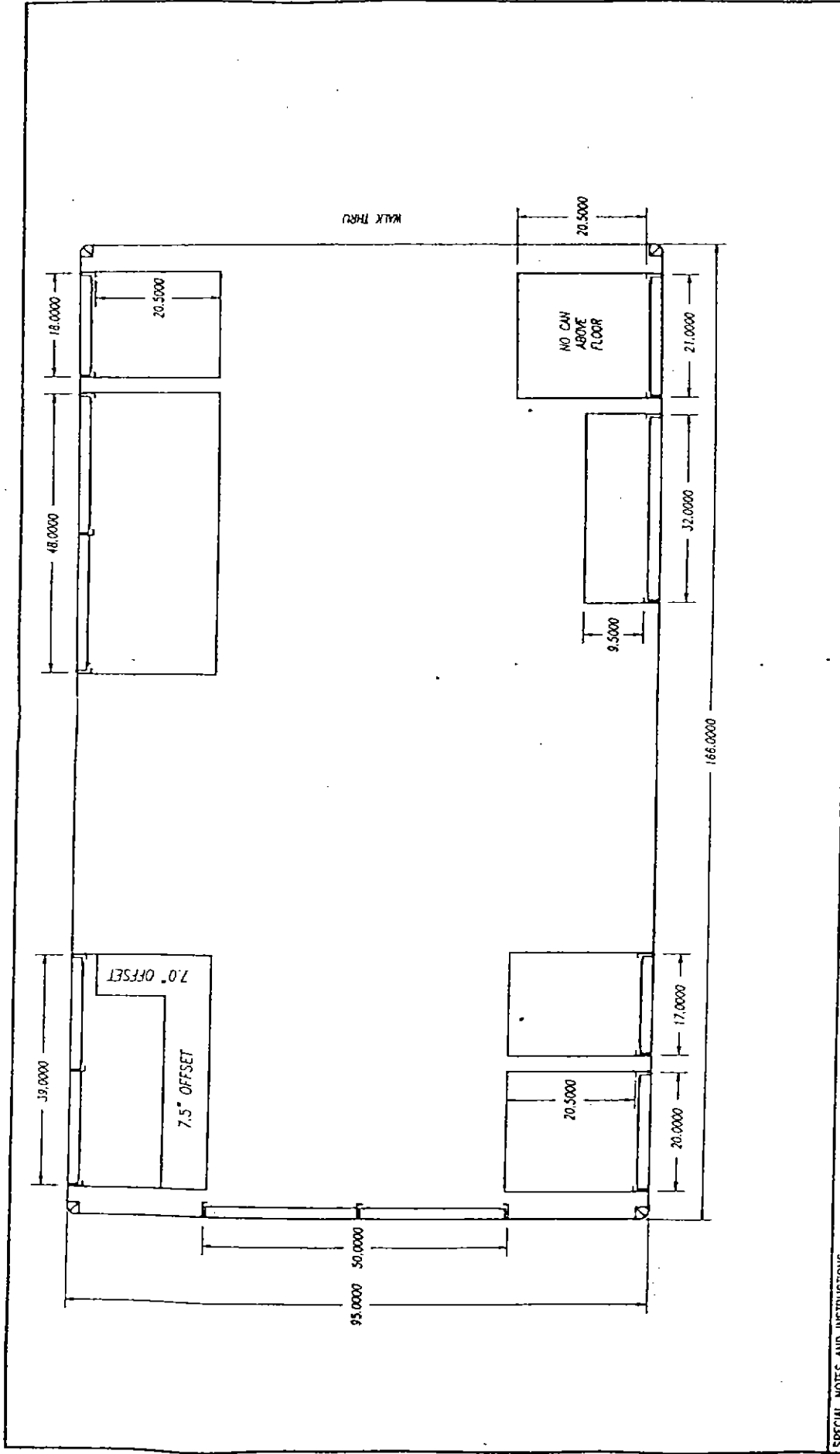

SPECIAL NOTES AND INSTRUCTIONS -

UNIT # 4289

CUSTOMER APPROVAL:

DATE:

EMPHASIS SHOWN ARE APPROXIMATE AND ARE SUBJECT TO MINOR DEVIATION AS MAY OCCUR OR BE NECESSARY FOR CONSTRUCTION. UNLESS OTHERWISE NOTED, DIMENSIONS ARE TO FACE.



CUSTOMER - DOWNER GROVE F.D.

DRAWN BY - SEB  
 DATE - 1/18/00  
 MODEL - VOYAGER II-A 166"

ORDER NO.  
 SCALE -  
 ANGLE - 95°  
 ANGLE - 72°

ISSUED TO D4285-00-4

Federal Signal Corp.  
 2645 Federal Signal Drive  
 University Park, IL 60466  
 708-534-3400

# Federal Signal

Medtec Ambulance Corp.  
 P.O. Box 821  
 64657 US 33 East  
 Goshen, IN 46526-0821  
 (219)534-2631

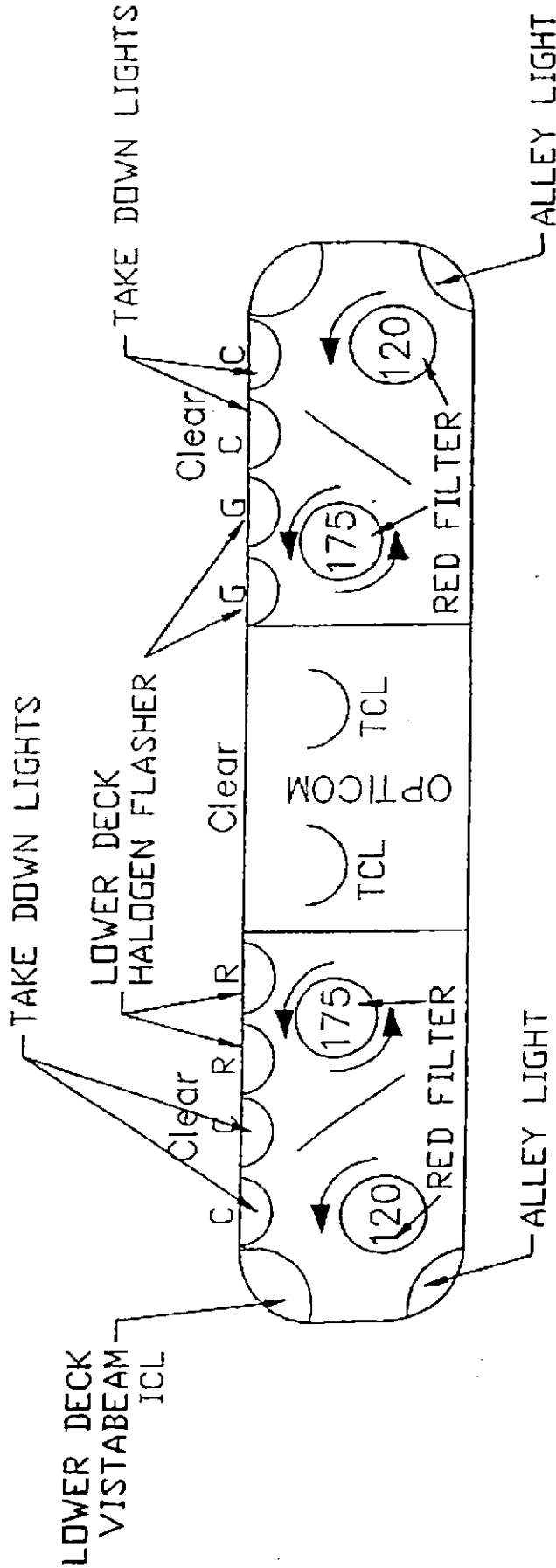

REVISED 2/25/00

175 fpm (fast) rotators

95 fpm (standard) rotators / diagonal mirrors

PO#	Order	MFG.Part NO.	Dealer:	Customer:
-----	4285 4289	62" VISTA	Foster Coach	DOWNER GROVE F.D.

Medtec Ambulance Corporation

P.O. Box 821  
 Goshen, Indiana 46527-0821  
 219-534-2631

Whelen Engineering

Route 145 Winthrop Road  
 Chester, Connecticut 06412-0684  
 203-526-9504 Fax: 526-4078

5000--KKKRS ADVANTEDGE PLUS LIGHTBAR

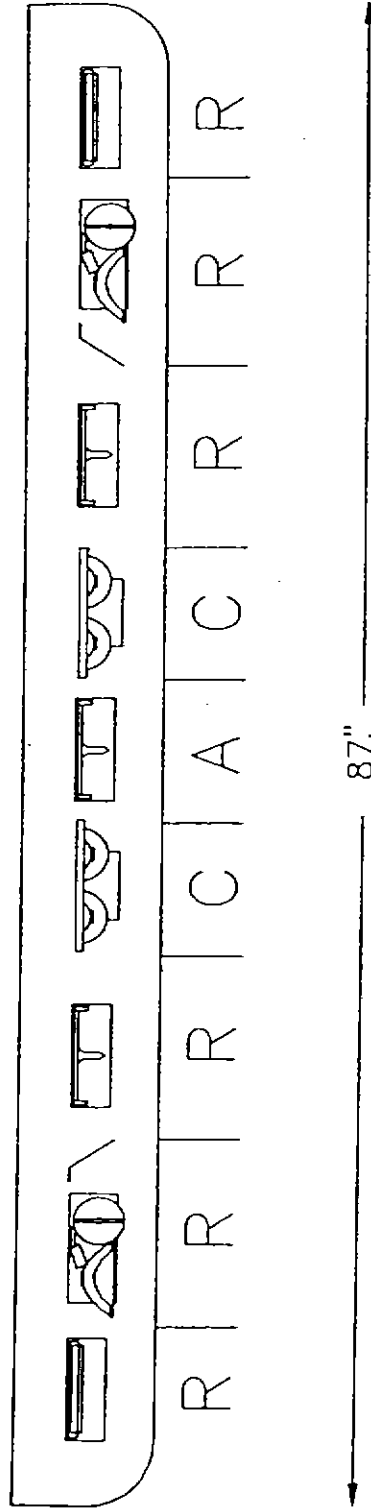

DIRECTION HALOGEN LAMP

64 SERIES LINEAR STROBE

DIRECTIONAL HALOGEN LAMPS

OSCILLATING HALOGEN LAMPS

V-MIRROR

REVISED 2/25/00

P.O. Number	Order Number	Model Number	Dealer	Customer
	4285,4289	5000-KKKRS	Foster Coach	DOWNER GROVE

ALL DIMENSIONS LEADING TO ROOF ARE TAKEN FROM TOP OF DRIP RAIL

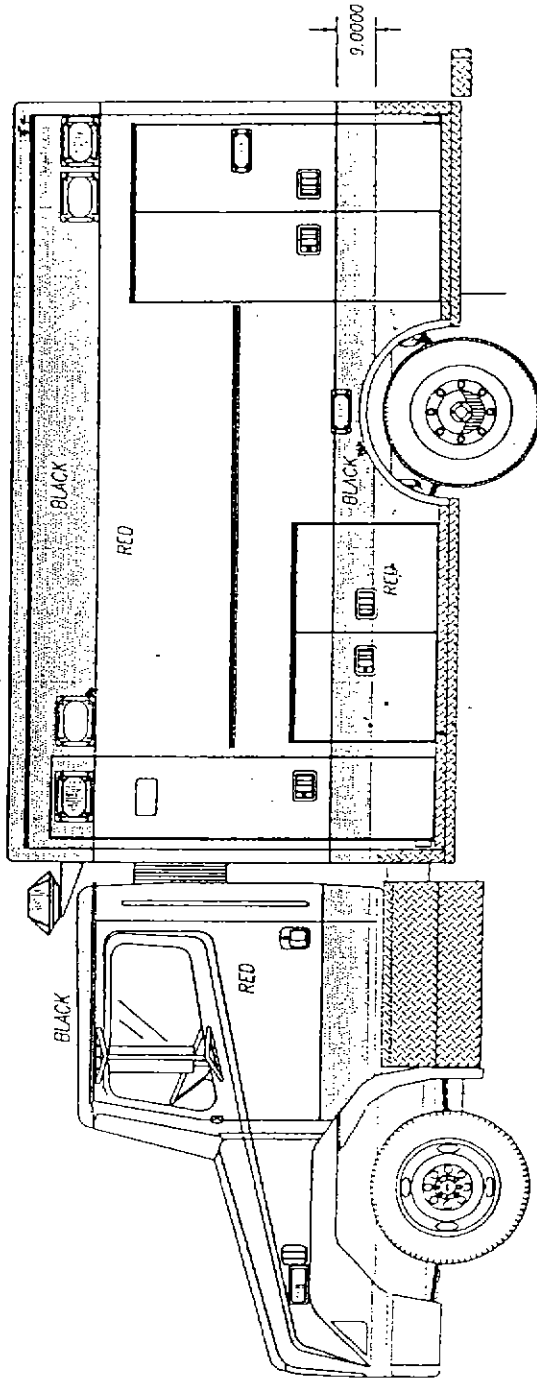

ALWAYS USE PPC COLOR CODES

CAB COLOR: RED  PAINT  GON  
 BODY COLOR: RED  PAINT  Z1663  
 CENTER BAND: BLACK  PAINT/ELECTRIC SCOUR/ITE  
 PW:  YES  NO  
 HOOD BAND:  YES  NO

SALE -	FOSTER COACH	PART STYLE -	CUSTOM
DIMENSIONS SHOWN ARE APPROXIMATE AND ARE SUBJECT TO MINOR DEVIATIONS AS MAY OCCUR OR BE NECESSARY IN CONSTRUCTION.		CUSTOMER -	DOWNER GROVE F.D.
DATE -	1/27/00	ORDER -	4285,4289
DRIVE BY -	SEB	DRIVER -	92.5" HIGH
SALE NO. -	1 OF 2	TYPE -	VOYAGER II - A
		ORDER NO.	04285-00-F

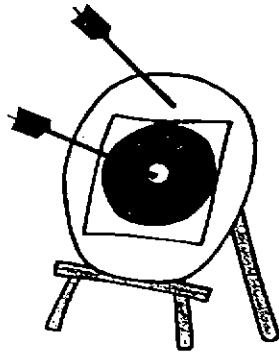
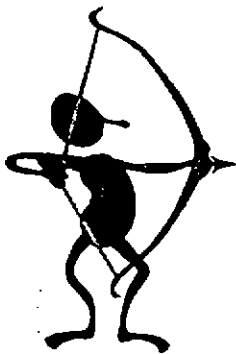

# ORDER APPROVAL FORM

DATE: MARCH 27, 2000

TO: RAY HENSHAW

FROM: STACY GINGERICH

DOWNERS GROVE FIRE DEPARTMENT  
ORDER #4285 AND #4289

As Is

MAKE CHANGES

BODY

\_\_\_\_\_

\_\_\_\_\_

LIGHT BAR

\_\_\_\_\_

\_\_\_\_\_

PAINT SCHEME

\_\_\_\_\_

\_\_\_\_\_

CONVERSION

\_\_\_\_\_

\_\_\_\_\_

SWITCH PANELS

\_\_\_\_\_

\_\_\_\_\_

DEALER APPROVAL SIGNATURE: \_\_\_\_\_

COMMENTS: \_\_\_\_\_

\_\_\_\_\_

\_\_\_\_\_

\_\_\_\_\_

\_\_\_\_\_

\_\_\_\_\_

\_\_\_\_\_

\_\_\_\_\_

Customer Name: DOWNER GROVE  
 Unit Number: 4285, 4289

Dealer: FOSTER COACH  
 Salesman: RH

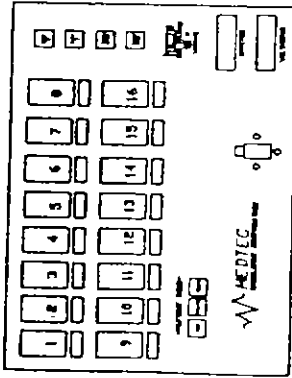

**FRONT SWITCH PANEL**

**Switch Description**

1. Blank
2. Master
3. Halogen Flashers
4. Strobe Intersection
5. Front Lightbar (3-Position)
6. Rear Light Bar
7. Wig-Wag
8. Siren/Air/Horn
9. Opticom
10. Alley Lights
11. Left Scenes
12. Rear Loads
13. Right Scenes
14. Door Locks
15. Module Disconnect Date \_\_\_\_\_
16. Air Horns

Customer Approval \_\_\_\_\_

Dealer Approval \_\_\_\_\_

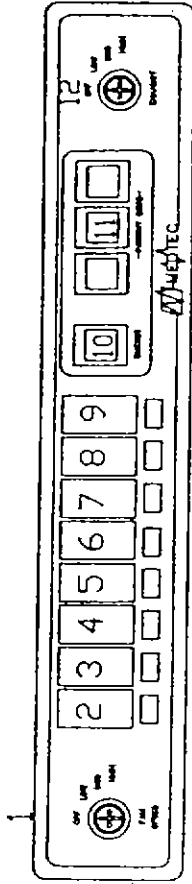

**REAR SWITCH PANEL**

**Switch Description**

1. Blank
2. Left Domes
3. Right Domes
4. Fluorescent Lights
5. Oxygen
6. Suction Pump
7. Spare Switch
8. blank
9. Module Disconnect
10. Buzzer
11. Code Lights
12. Exhaust

Electrical Department \_\_\_\_\_

Panels assembled per specification and tested

Signature \_\_\_\_\_